

Created with

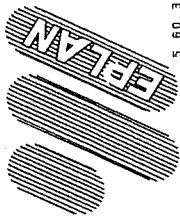

5.60.3

Manufacturer : AREVA
Energietechnik GmbH
Plant designation: LowVoltMainDistr

Drawing number :
Project : Kosice
Project No. :
Disk No. :

Project start : 07.05.05
Responsible for project : Otten
Last change : 28.12.05
Last user : BRE

Number of pages : 378

Date		07.05.05		Act.		LVMD		AREVA		ATR		Cover		Zust.		Pg.		= LVMD		Pg.		Pg.	
Rev03		28.12.05		BRE		Checked		Editor		Otten		Area		Kosice		System		LowVoltMainDistr		Project-No.		1_169_05_20	
State		Date		Name		Name		Name		Name		Name		Name		Name		Name		Name		Name	
1		2		3		4		5		6		7		8		9		10		11		12	
1		2		3		4		5		6		7		8		9		10		11		12	
1		2		3		4		5		6		7		8		9		10		11		12	

1		2		3		4		5		6		7		8	
Table of contents															
A															
System-/Functionsgrp. -/Page-Comment															
+ Area															
Page															
Last state															
Drawing No.															
Page															
Reserve															
MCC Unit M13100															
MCC Unit M13200															
+Field2-X5															
+Field2-XH2															
+Field2-XS2.5.1															
+Field2-XS2.5.2															
+Field2-XS2.5.3															
+Field2-XS2.5A															
+Field2-XS2.5B															
+Field2-XS2.5C															
+Field2-XS2.6.1															
+Field2-XS2.6.2															
+Field2-XS2.6.3															
+Field2-XS2.6A															
+Field2-XS2.6B															
+Field2-XS2.6C															
+Field2-XS2.8.1															
+Field2-XS2.8.2															
+Field2-XS2.8.3															
+Field2-XS2.8A															
+Field2-XS2.8B															
+Field2-XS2.8C															
+Field2-XS2.9.1															
+Field2-XS2.9.2															
+Field2-XS2.9.3															
+Field2-XS2.9A															
+Field2-XS2.9B															
+Field2-XS2.9C															
Reserve															
MCC Unit M24282															
MCC Unit M24182															
MCC Unit M77803															
MCC Unit M77803															
MCC Unit M11803															
MCC Unit M11803															
MCC Unit M16803															
MCC Unit M16803															
MCC Unit M16803															
MCC Unit M624101															
MCC Unit M624101															
B															
C															
D															
E															
F															
Table of contents															
AIR															
Liquide															
AREVA															
Energie-technik GmbH															
Created with EPLAN 5.50															
3															
4															
5															
6															
7															
8															
Rev03															
28.12.05															
BRE															
Checked															
Name															
Date															
1															
2															
3															
4															
5															
6															
7															
8															
Zust.															
Pg.															
3															
= LVMD															
378															
Pg.															
3															
Project-No.															
1_169_05_20															
3551/169-05															
Pg.															
22															
Pg.															
8															

Table of contents

[illegible]

[illegible]

```
+LWVD      Low Voltage Main Distribution
+Field1...12 General building, field 1 to 12
CB         Control cabinet
ES         Emergency stop
```

[illegible]

400V AC : 3/N, PE

L1-L3

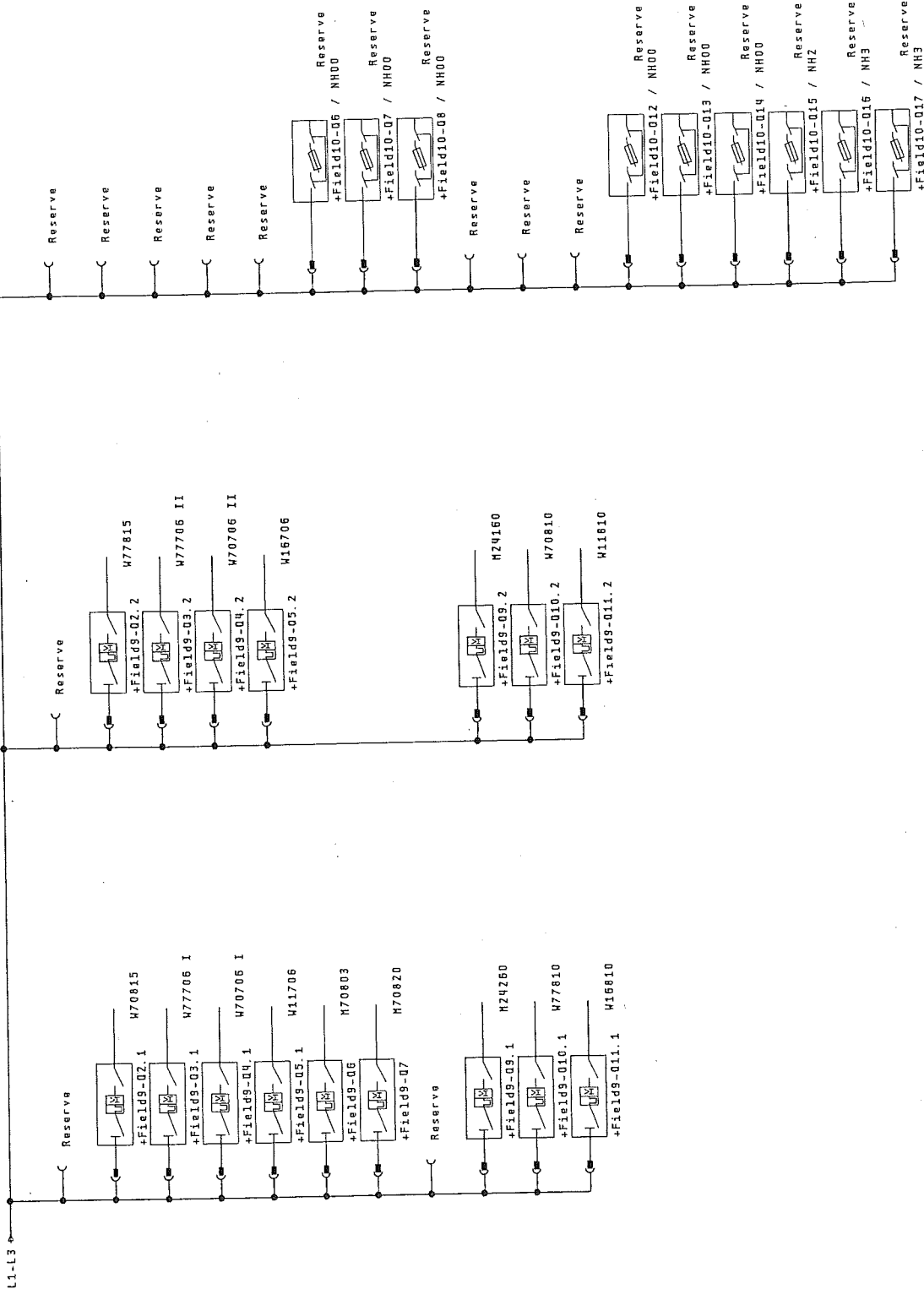

Date		07.05.05	Act	LVND	Date		07.05.05	Act	LVND
Editor		Ottien	Area	Kosica	Editor		Ottien	Area	Kosica
BRE		Checked	System	LowVoltMainDistr	BRE		Checked	System	LowVoltMainDistr
Date		28.12.05	State	Rev03	Date		28.12.05	State	Rev03
AREVA Energietechnik GmbH					AIR Liquide				
Created with EPLAN 5.50					General view 1pol.				
Project-No. 1_169_05.20					Project-No. 1_169_05.20				
Disk-No. 3551/169-05					Disk-No. 3551/169-05				
Zust. Pg. 16					Zust. Pg. 16				
= LVND					= LVND				
378 Pg. +					378 Pg. +				
Pg. 16					Pg. 16				
22 Pg.					22 Pg.				

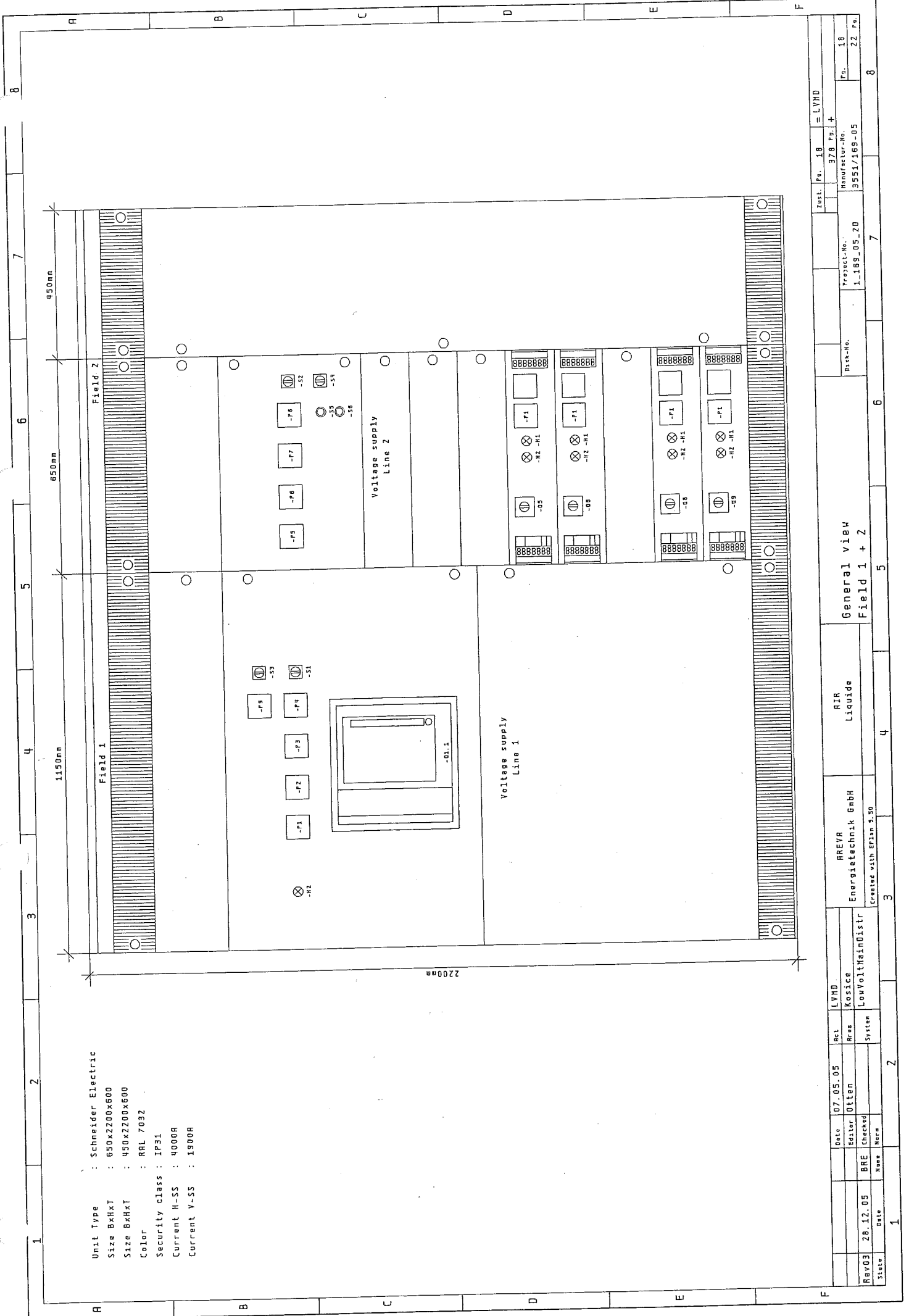

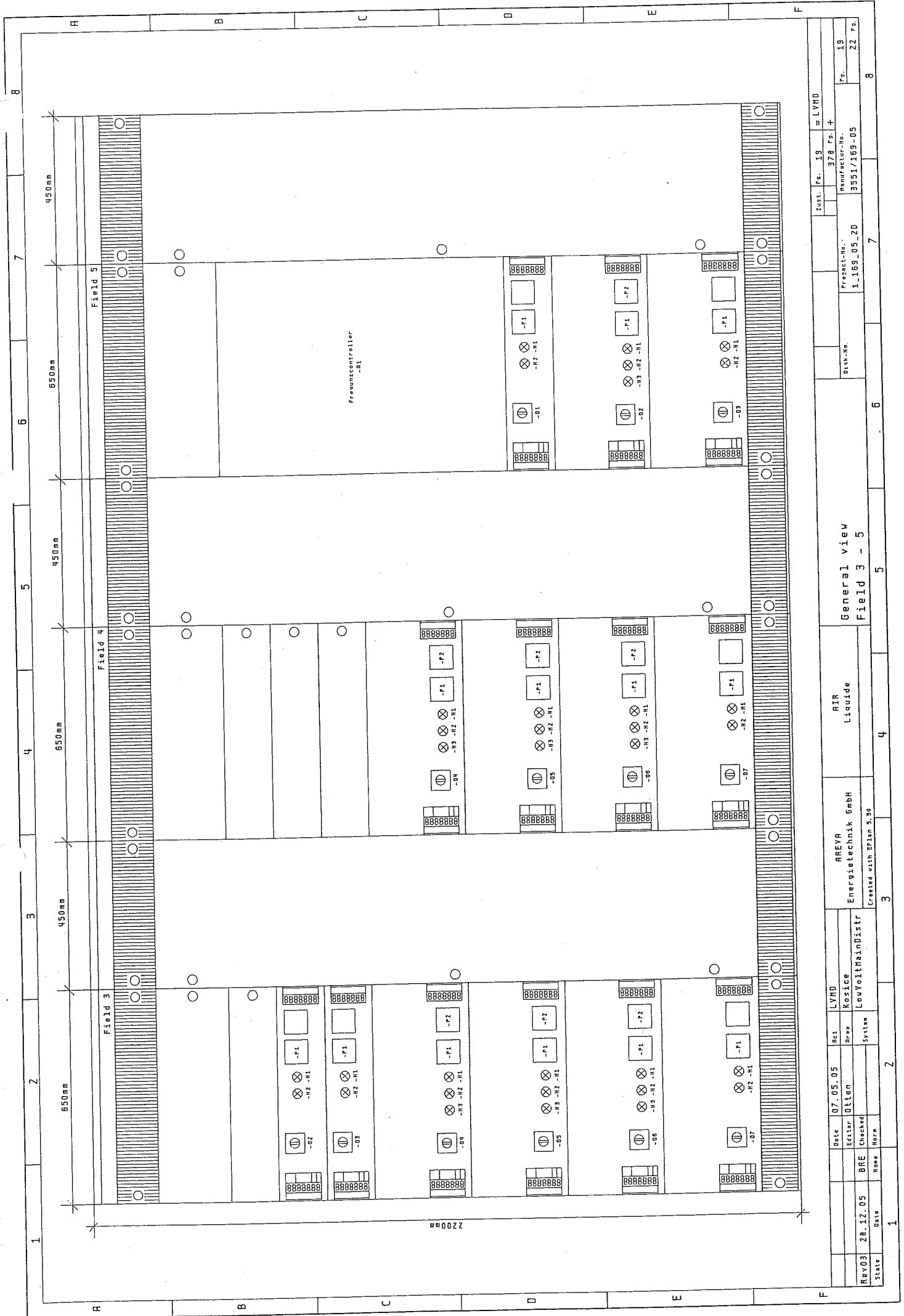

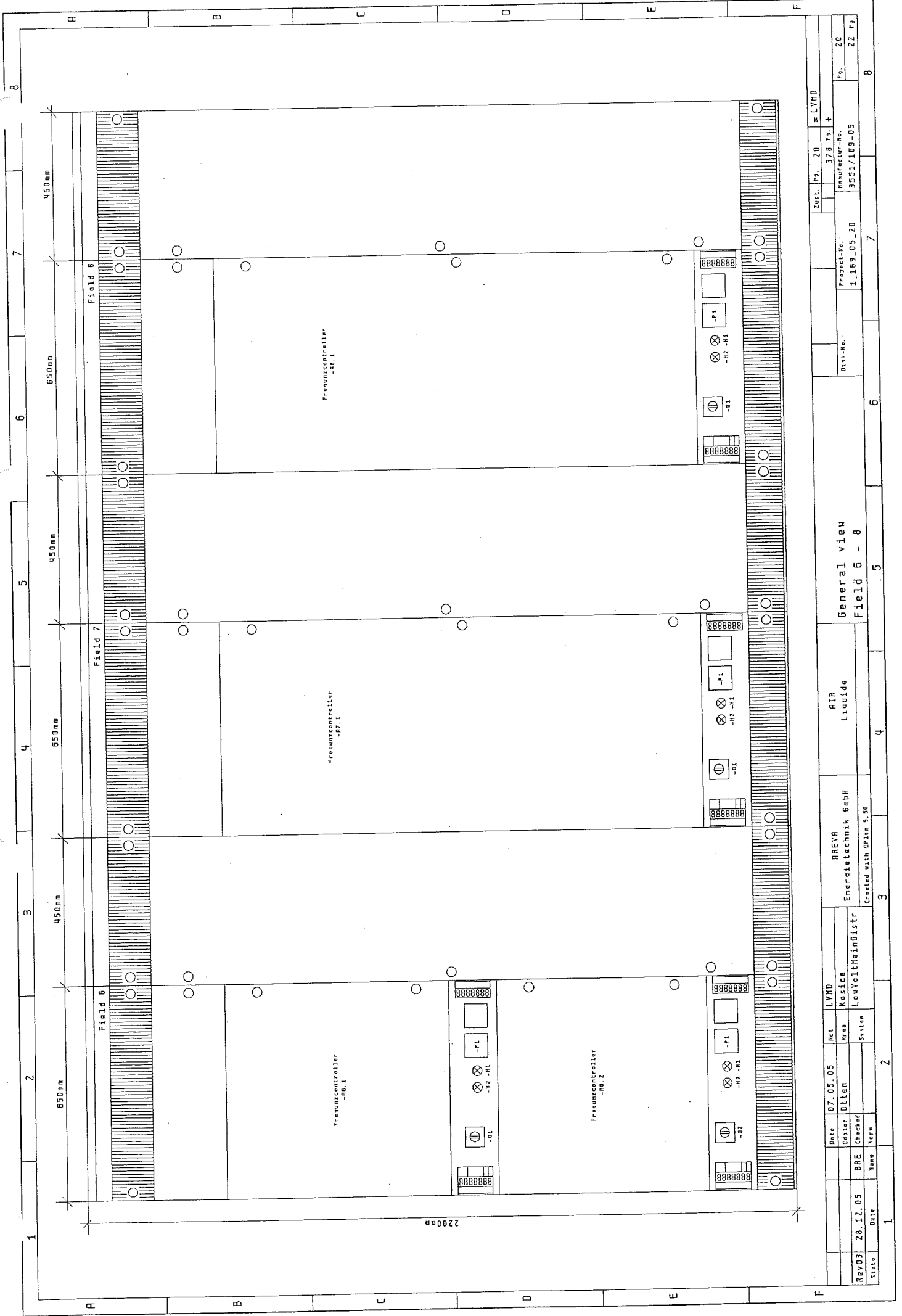

Date		07.05.05	Act	LYND	AREVA		AIR		General view		Zust.		Pg. 20 = LVND	
Editor		Otten	Free	Kosice	Energietechnik GmbH		Liquide		Field 6 - 8		Pg. 378 Pg. +		Pg. 20	
BRE		Checked	System	LouVollMainDistr	Created with EPLAN 5.50				Project-No. 1.169.05.20		Pg. 22 Pg.		Pg. 22 Pg.	
State		Date	Name						Disk-No. 3551/189-05					

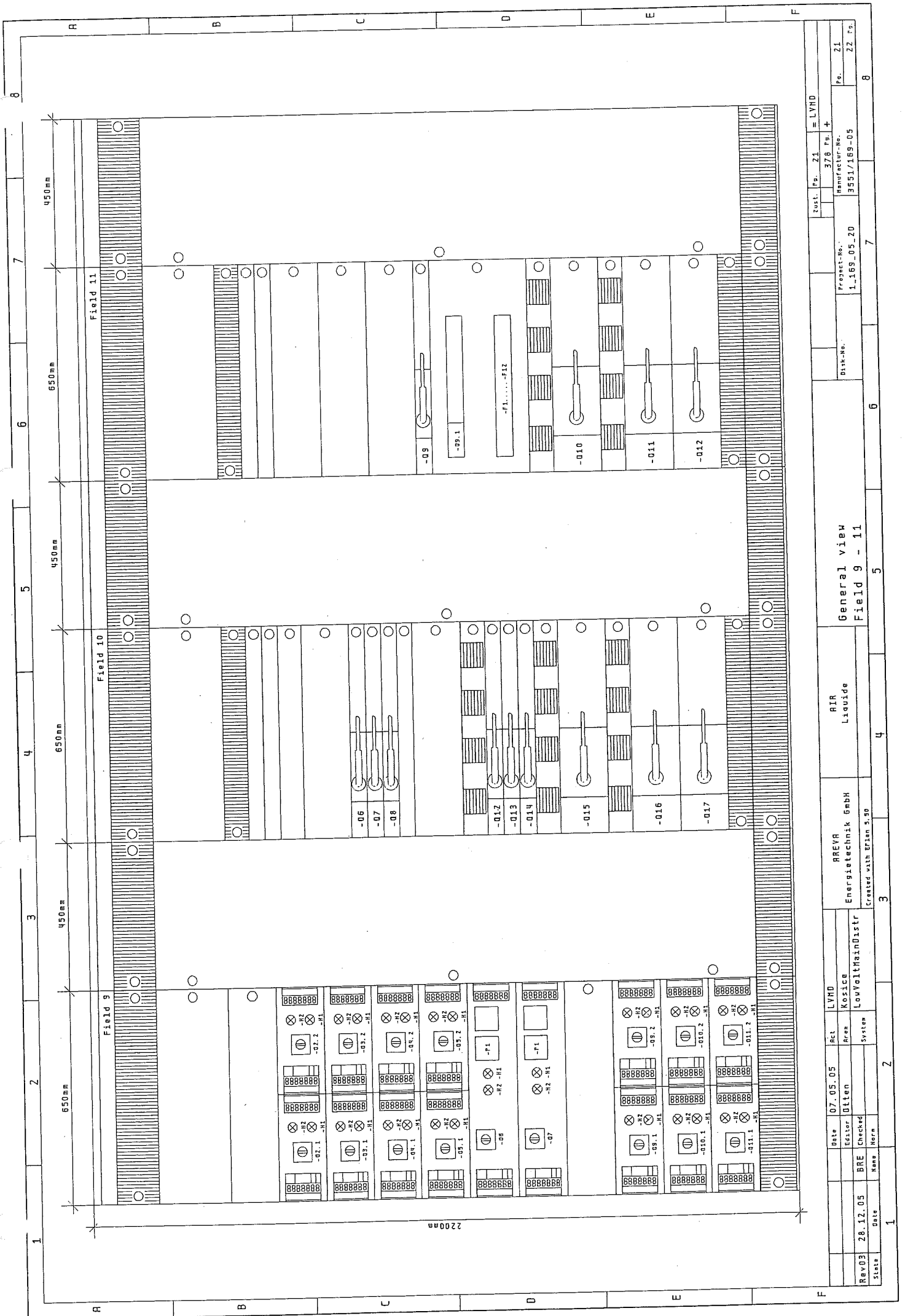

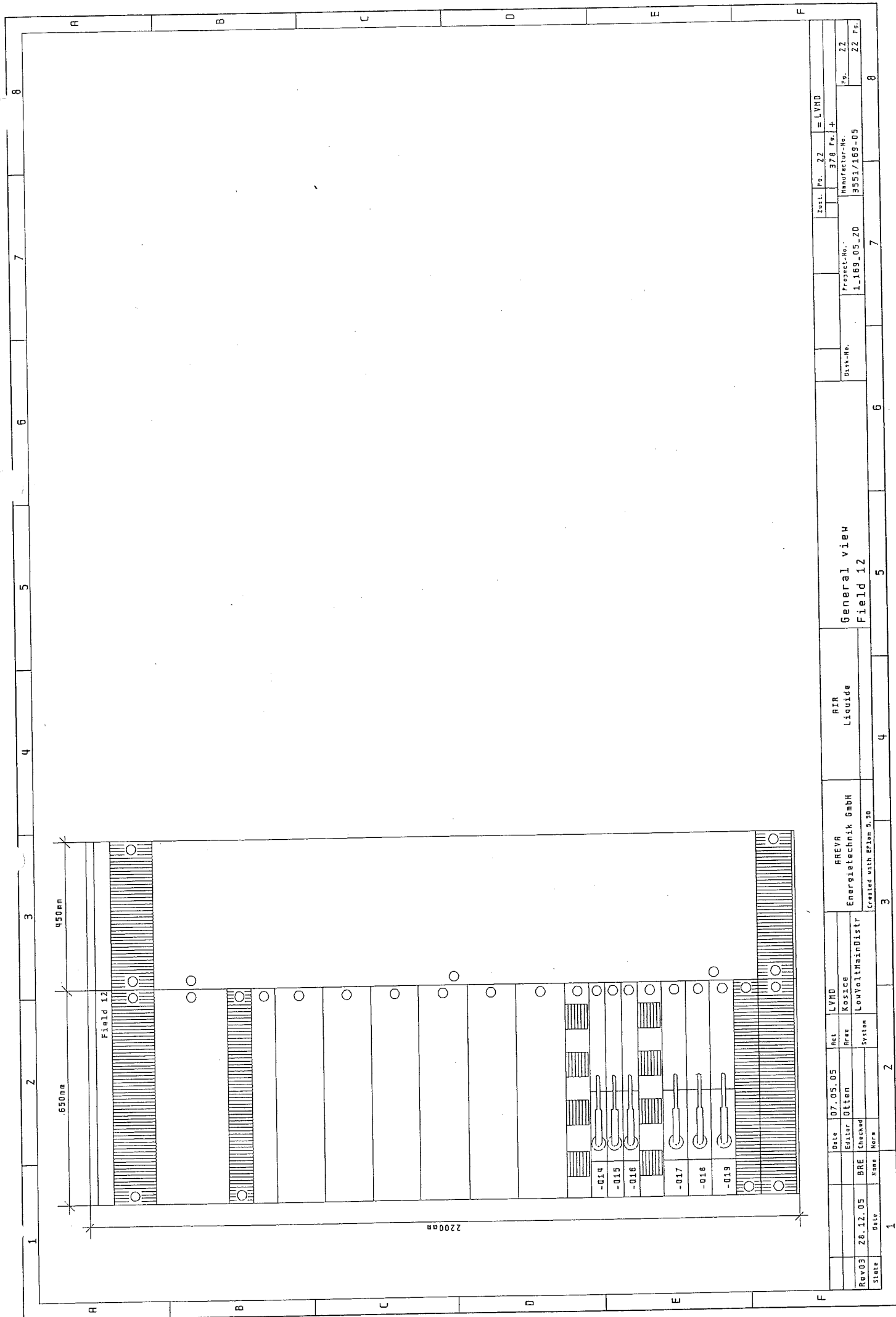

Fault
Flavm

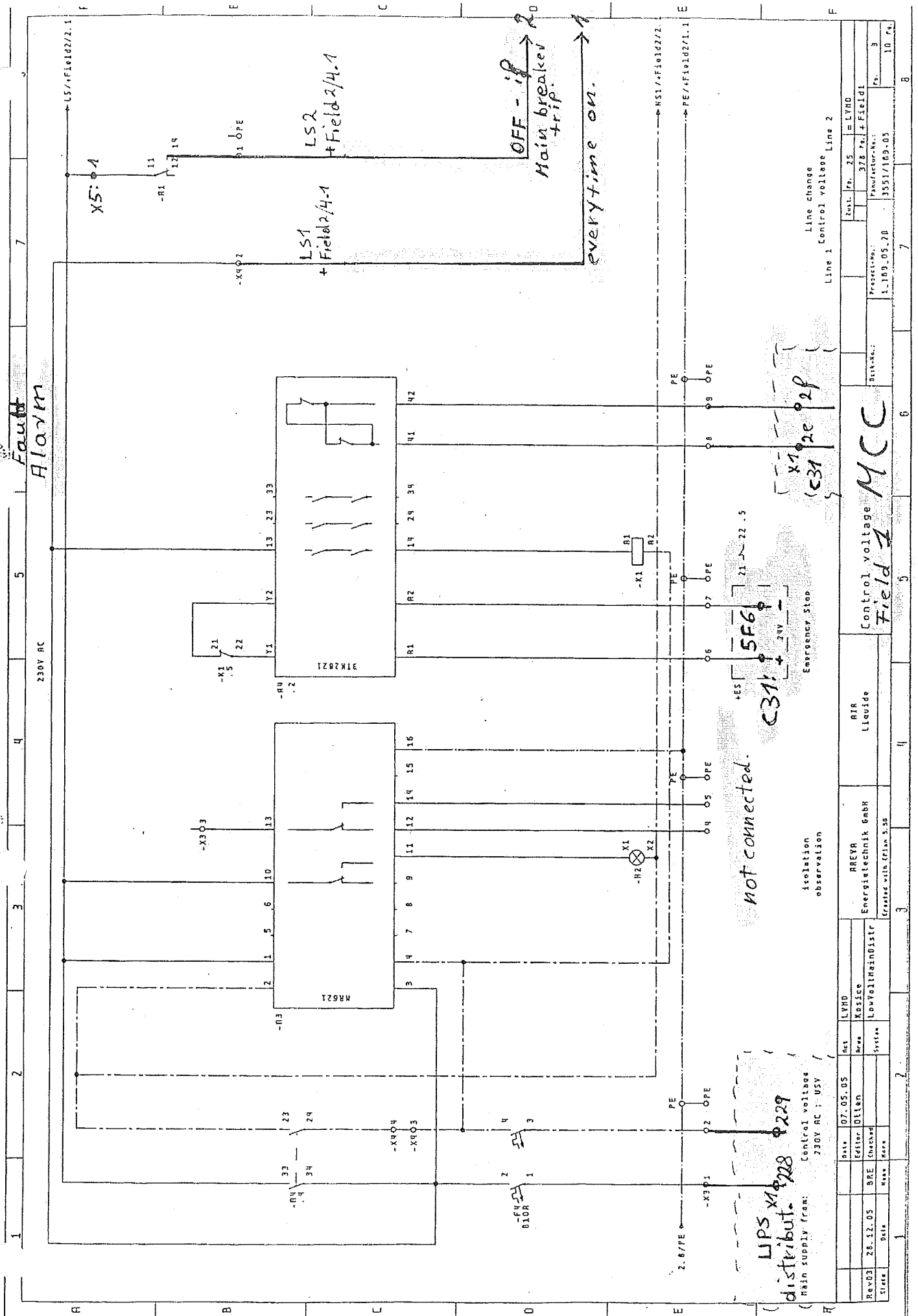
[illegible]

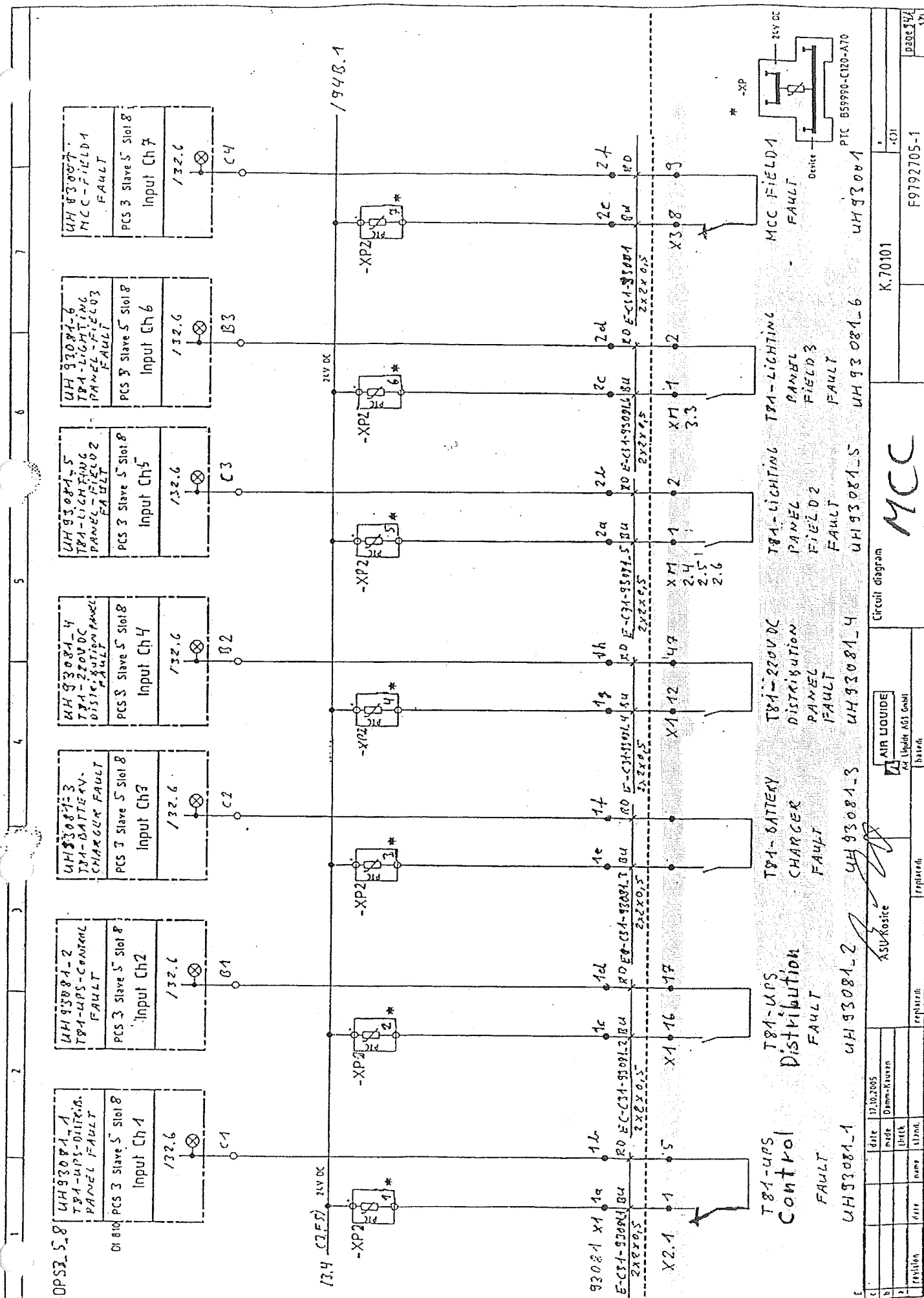

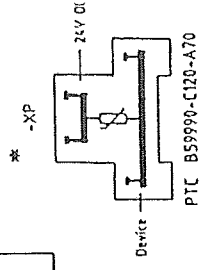
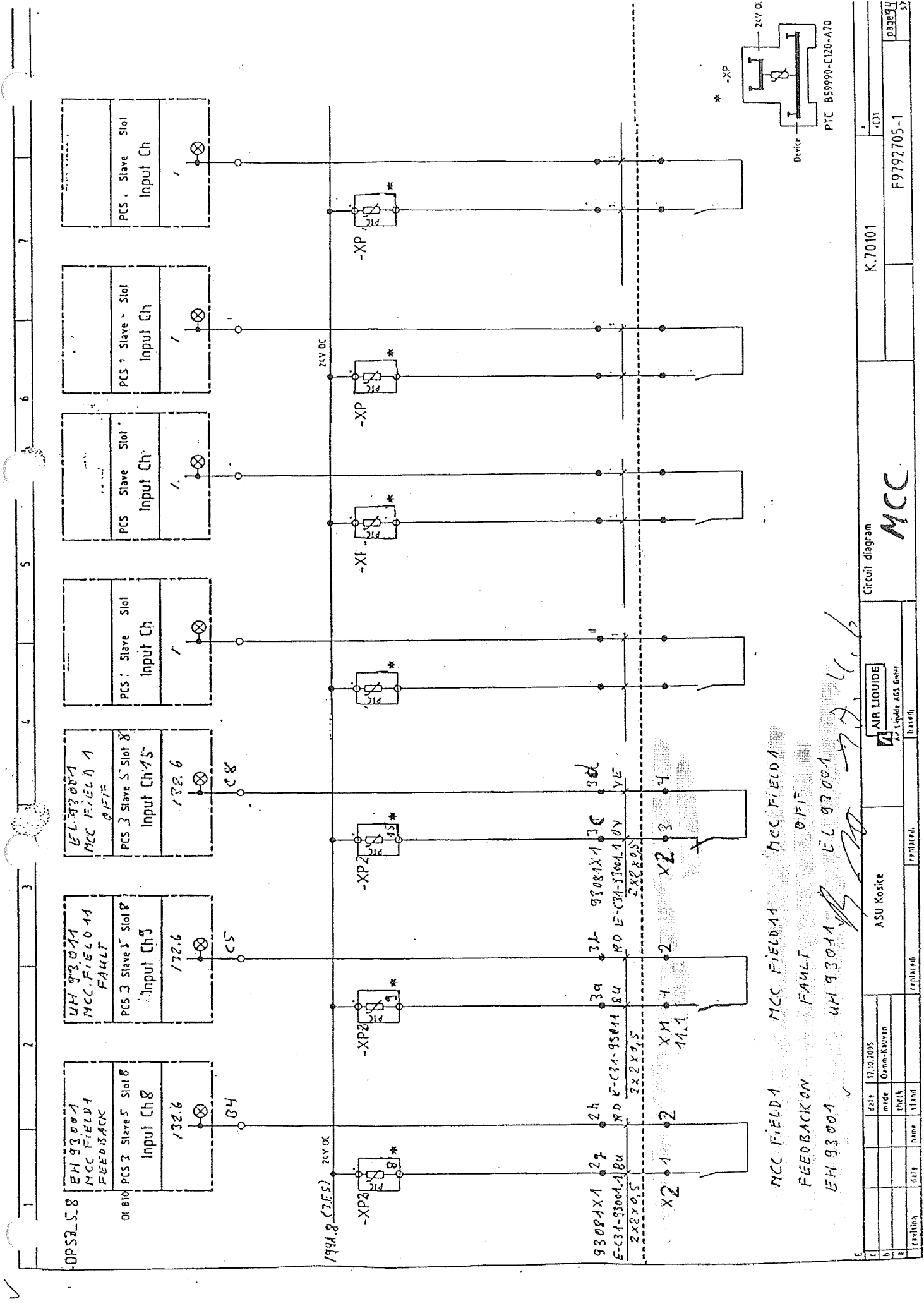

PTC BS9990-C120-A70
K.70101
F9792705-1
page 94

Circuit diagram

MCC

AIR LIQUIDE

ASU Kosite

date 12.02.2005
made Omm-Kuuten
check
name
value

replaced

replaced

replaced

replaced

[illegible]

1	2	3	4	5	6	7	8
terminalblock: +Field1-X2							
end		end		end		end	
notes and identification		notes and identification		notes and identification		notes and identification	
Link		Link		Link		Link	
Clampnumber		Clampnumber		Clampnumber		Clampnumber	
1		1		1		1	
2		2		2		2	
3		3		3		3	
4		4		4		4	
5		5		5		5	
6		6		6		6	
7		7		7		7	
8		8		8		8	
9		9		9		9	
10		10		10		10	
11		11		11		11	
12		12		12		12	
13		13		13		13	
14		14		14		14	
15		15		15		15	
16		16		16		16	
17		17		17		17	
18		18		18		18	
19		19		19		19	
20		20		20		20	
21		21		21		21	
22		22		22		22	
23		23		23		23	
24		24		24		24	
25		25		25		25	
26		26		26		26	
27		27		27		27	
28		28		28		28	
29		29		29		29	
30		30		30		30	
31		31		31		31	
32		32		32		32	
33		33		33		33	
34		34		34		34	
35		35		35		35	
36		36		36		36	
37		37		37		37	
38		38		38		38	
39		39		39		39	
40		40		40		40	
41		41		41		41	
42		42		42		42	
43		43		43		43	
44		44		44		44	
45		45		45		45	
46		46		46		46	
47		47		47		47	
48		48		48		48	
49		49		49		49	
50		50		50		50	
51		51		51		51	
52		52		52		52	
53		53		53		53	
54		54		54		54	
55		55		55		55	
56		56		56		56	
57		57		57		57	
58		58		58		58	
59		59		59		59	
60		60		60		60	
61		61		61		61	
62		62		62		62	
63		63		63		63	
64		64		64		64	
65		65		65		65	
66		66		66		66	
67		67		67		67	
68		68		68		68	
69		69		69		69	
70		70		70		70	
71		71		71		71	
72		72		72		72	
73		73		73		73	
74		74		74		74	
75		75		75		75	
76		76		76		76	
77		77		77		77	
78		78		78		78	
79		79		79		79	
80		80		80		80	
81		81		81		81	
82		82		82		82	
83		83		83		83	
84		84		84		84	
85		85		85		85	
86		86		86		86	
87		87		87		87	
88		88		88		88	
89		89		89		89	
90		90		90		90	
91		91		91		91	
92		92		92		92	
93		93		93		93	
94		94		94		94	
95		95		95		95	
96		96		96		96	
97		97		97		97	
98		98		98		98	
99		99		99		99	
100		100		100		100	

MCC		+Field1-X2		Field 1		8	
378		378		378		378	
3551/189-05		3551/189-05		3551/189-05		3551/189-05	
1.189.05.20		1.189.05.20		1.189.05.20		1.189.05.20	
1		2		3		4	
5		6		7		8	

[illegible]

	1	2	3	4	5	6	7	8	9	10	11	12	13	14	15	16	17	18	19	20	21	22	23	24	25	26	27	28	29	30	31	32	33	34	35	36	37	38	39	40	41	42	43	44	45	46	47	48	49	50	51	52	53	54	55	56	57	58	59	60	61	62	63	64	65	66	67	68	69	70	71	72	73	74	75	76	77	78	79	80	81	82	83	84	85	86	87	88	89	90	91	92	93	94	95	96	97	98	99	100	101	102	103	104	105	106	107	108	109	110	111	112	113	114	115	116	117	118	119	120	121	122	123	124	125	126	127	128	129	130	131	132	133	134	135	136	137	138	139	140	141	142	143	144	145	146	147	148	149	150	151	152	153	154	155	156	157	158	159	160	161	162	163	164	165	166	167	168	169	170	171	172	173	174	175	176	177	178	179	180	181	182	183	184	185	186	187	188	189	190	191	192	193	194	195	196	197	198	199	200	201	202	203	204	205	206	207	208	209	210	211	212	213	214	215	216	217	218	219	220	221	222	223	224	225	226	227	228	229	230	231	232	233	234	235	236	237	238	239	240	241	242	243	244	245	246	247	248	249	250	251	252	253	254	255	256	257	258	259	260	261	262	263	264	265	266	267	268	269	270	271	272	273	274	275	276	277	278	279	280	281	282	283	284	285	286	287	288	289	290	291	292	293	294	295	296	297	298	299	300	301	302	303	304	305	306	307	308	309	310	311	312	313	314	315	316	317	318	319	320	321	322	323	324	325	326	327	328	329	330	331	332	333	334	335	336	337	338	339	340	341	342	343	344	345	346	347	348	349	350	351	352	353	354	355	356	357	358	359	360	361	362	363	364	365	366	367	368	369	370	371	372	373	374	375	376	377	378	379	380	381	382	383	384	385	386	387	388	389	390	391	392	393	394	395	396	397	398	399	400	401	402	403	404	405	406	407	408	409	410	411	412	413	414	415	416	417	418	419	420	421	422	423	424	425	426	427	428	429	430	431	432	433	434	435	436	437	438	439	440	441	442	443	444	445	446	447	448	449	450	451	452	453	454	455	456	457	458	459	460	461	462	463	464	465	466	467	468	469	470	471	472	473	474	475	476	477	478	479	480	481	482	483	484	485	486	487	488	489	490	491	492	493	494	495	496	497	498	499	500	501	502	503	504	505	506	507	508	509	510	511	512	513	514	515	516	517	518	519	520	521	522	523	52
--	---	---	---	---	---	---	---	---	---	----	----	----	----	----	----	----	----	----	----	----	----	----	----	----	----	----	----	----	----	----	----	----	----	----	----	----	----	----	----	----	----	----	----	----	----	----	----	----	----	----	----	----	----	----	----	----	----	----	----	----	----	----	----	----	----	----	----	----	----	----	----	----	----	----	----	----	----	----	----	----	----	----	----	----	----	----	----	----	----	----	----	----	----	----	----	----	----	----	----	-----	-----	-----	-----	-----	-----	-----	-----	-----	-----	-----	-----	-----	-----	-----	-----	-----	-----	-----	-----	-----	-----	-----	-----	-----	-----	-----	-----	-----	-----	-----	-----	-----	-----	-----	-----	-----	-----	-----	-----	-----	-----	-----	-----	-----	-----	-----	-----	-----	-----	-----	-----	-----	-----	-----	-----	-----	-----	-----	-----	-----	-----	-----	-----	-----	-----	-----	-----	-----	-----	-----	-----	-----	-----	-----	-----	-----	-----	-----	-----	-----	-----	-----	-----	-----	-----	-----	-----	-----	-----	-----	-----	-----	-----	-----	-----	-----	-----	-----	-----	-----	-----	-----	-----	-----	-----	-----	-----	-----	-----	-----	-----	-----	-----	-----	-----	-----	-----	-----	-----	-----	-----	-----	-----	-----	-----	-----	-----	-----	-----	-----	-----	-----	-----	-----	-----	-----	-----	-----	-----	-----	-----	-----	-----	-----	-----	-----	-----	-----	-----	-----	-----	-----	-----	-----	-----	-----	-----	-----	-----	-----	-----	-----	-----	-----	-----	-----	-----	-----	-----	-----	-----	-----	-----	-----	-----	-----	-----	-----	-----	-----	-----	-----	-----	-----	-----	-----	-----	-----	-----	-----	-----	-----	-----	-----	-----	-----	-----	-----	-----	-----	-----	-----	-----	-----	-----	-----	-----	-----	-----	-----	-----	-----	-----	-----	-----	-----	-----	-----	-----	-----	-----	-----	-----	-----	-----	-----	-----	-----	-----	-----	-----	-----	-----	-----	-----	-----	-----	-----	-----	-----	-----	-----	-----	-----	-----	-----	-----	-----	-----	-----	-----	-----	-----	-----	-----	-----	-----	-----	-----	-----	-----	-----	-----	-----	-----	-----	-----	-----	-----	-----	-----	-----	-----	-----	-----	-----	-----	-----	-----	-----	-----	-----	-----	-----	-----	-----	-----	-----	-----	-----	-----	-----	-----	-----	-----	-----	-----	-----	-----	-----	-----	-----	-----	-----	-----	-----	-----	-----	-----	-----	-----	-----	-----	-----	-----	-----	-----	-----	-----	-----	-----	-----	-----	-----	-----	-----	-----	-----	-----	-----	-----	-----	-----	-----	-----	-----	-----	-----	-----	-----	-----	-----	-----	-----	-----	-----	-----	-----	-----	-----	-----	-----	-----	-----	-----	-----	-----	-----	-----	-----	-----	-----	-----	-----	-----	-----	-----	-----	-----	-----	-----	-----	-----	-----	-----	-----	-----	-----	-----	-----	-----	-----	-----	-----	-----	-----	-----	-----	-----	-----	-----	-----	-----	-----	-----	-----	-----	-----	-----	-----	-----	-----	-----	-----	-----	-----	-----	-----	-----	-----	-----	-----	-----	-----	-----	-----	-----	-----	-----	-----	-----	-----	-----	----

[illegible]

[illegible]

terminalblock: +Field1-XW1

and

notes and
identification

Link

Classnumber

end

notes and
identification

LVHD-P1: 1
LVHD-P2: 2
LVHD-P3: 1
LVHD-P4: 2
LVHD-P5: 1
LVHD-P6: 2

1 - LVHD-T1
2 - LVHD-T1
3 - LVHD-T2
4 - LVHD-T2
5 - LVHD-T3
6 - LVHD-T3

Rev03	28.12.05	Editor	07.05.05	Rev	LVHD	AREVA	RIR	+Field1-XW1	Field 1	Project-No.	378 Pa. +Field1	32	378 Pa. +Field1	10
State	28.12.05	Editor	07.05.05	Rev	LVHD	Energietechnik GmbH	Liquide			Dist-No.	1.169-05-20	32	378 Pa. +Field1	10
		Checked				Created with Eplan 5.30								



பிழைப்பு

Field 2

1		2		3		4		5		6		7		8	
<div>400V RC : 3/PE 50Hz : 50kV / 1sek.</div> <div> <div>1.8/L1</div> <div>1.8/L2</div> <div>1.8/L3</div> </div> <div> <div>LS1/5.1</div> <div>LS2/5.1</div> <div>LS3/5.1</div> </div>															
<div> <div>+Field1/3.7/LS1</div> <div>+Field1/3.8/LS2</div> <div>3.2/NS1</div> <div>1.8/PE</div> </div> <div> <div>LS1/5.1</div> <div>LS2/5.1</div> <div>NS1/5.1</div> <div>PE/5.1</div> </div>															

Date		07.05.05		Act		LVMD		Zust. No.		36		= LVMD	
Editor		Ottien		Area		Kosice		Product-No.		378		+ Field2	
Checked				System		LowVoltageInDistr		Manufacturer-No.		3551/169-05		Ps.	
Date		28.12.05		BRE		Name		Disk-No.		1_169_05_20		Ps.	
State		Rev03						Reserve		AIR		Liquide	
								AREVA		Energie-technik GmbH		Created with EPLAN 5.50	
								3		4		5	
								6		7		8	

400V AC : 3/PE 50Hz : 50kA / 1sek.

q. 8/L1

q. 8/L2

q. 8/L3

L1/6.1

L2/6.1

L3/6.1

q. 8/LS1

q. 8/LS2

q. 8/NS1

q. 8/PE

LS1/6.1

LS2/6.1

NS1/6.1

PE/6.1

Rev03	28.12.05	BRE	Checked	Date	10.05.05	Act	LYND	AREVA	AREVA Energietechnik GmbH	AIR	Reserve	Zust.	Pa.	37	= LYND	
State	Date	Name	Area	System	Editor	Area	Area	Area	Area	Area	Area	Project-No.	Project-No.	Project-No.	Project-No.	
					Otten		Kosice	Energietechnik GmbH	Energietechnik GmbH	Liquide	Reserve	1.169.05.20	1.169.05.20	3551/169-05	3551/169-05	
							LouVolthainDistr	Created with EPLAN 5.50								

1	2	3	4	5	6	7	8
<div> <div> <div>400V AC : 3/PE</div> <div>50Hz : 50kV / 1sek.</div> </div> <div> <div>5.8/L1</div> <div>5.8/L2</div> <div>5.8/L3</div> </div> <div> <div>5.8/LS1</div> <div>5.8/LS2</div> <div>5.8/NS1</div> <div>5.8/PE</div> </div> <div> <div>LS1/7.1</div> <div>LS2/7.1</div> <div>NS1/7.1</div> <div>PE/7.1</div> </div> </div>							
<div> <div> <div>5.8/LS1</div> <div>5.8/LS2</div> <div>5.8/NS1</div> <div>5.8/PE</div> </div> <div> <div>LS1/7.1</div> <div>LS2/7.1</div> <div>NS1/7.1</div> <div>PE/7.1</div> </div> </div>							

Rev03	Date	28.12.05	BRE	Checked	Date	07.05.05	Act	LVMD	Kosice	LowVoltMainDistr	AREVA Energietechnik GmbH	AIR Liquide	Reserve	Disk-No.	1.169_05_20	Project-No.	3551/169-05	378 Pe. + Field2	Zust. Pg. 38	= LVMD	Pg.	6	
																							37

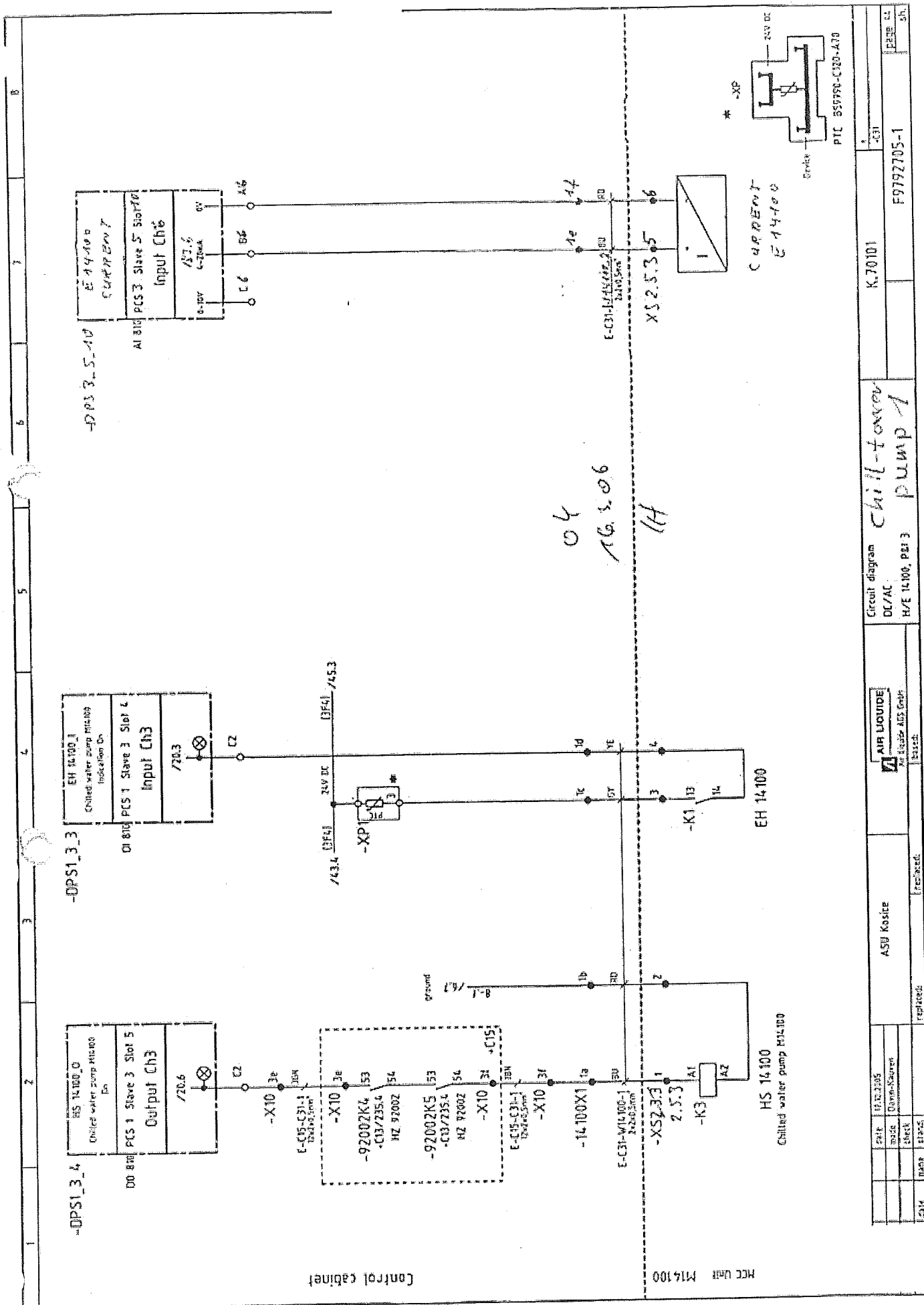

DATE	10-12-95	ASU Kosice	<input checked="" type="checkbox"/> AIR LIQUIDE <input type="checkbox"/> AIR FRANCE <input type="checkbox"/> AIR EUROPE	Circuit diagram DC/AC H/E 14/00, p21 3	chill-tonner pump 1	K.70101	-331	PAGE 42	F0792705-1	sh.
TIME	10:24									
BY	David Sauer									
REMARKS	replaced									

400V AC TYPE 50Hz / 50A / 13kV

Measurement
CURRENT

7.0/L1
7.0/L2
7.0/L3

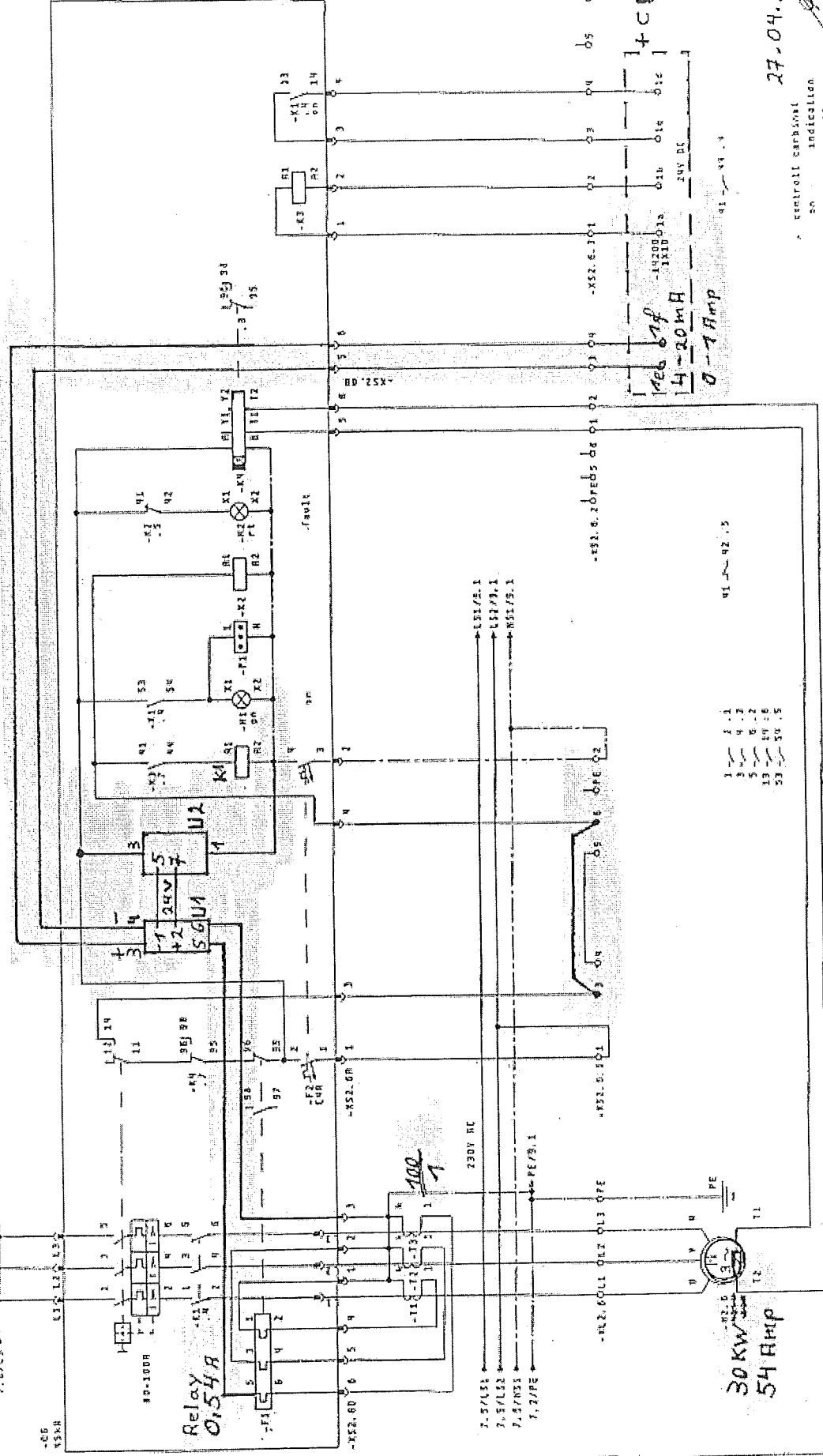

30kW
54Amp

1 1.1
2 1.2
3 1.3
4 1.4
5 1.5
13 1.6
53 1.7

27.04.2006
control cabinet
indication

HCC Unit
H14200

Emergency stop button
Emergency stop button

NO.	DATE	BY	REVISION
1	27.04.05	MS	1
2	28.12.05	ONE	2
3	28.12.05	ONE	3
4	28.12.05	ONE	4
5	28.12.05	ONE	5
6	28.12.05	ONE	6
7	28.12.05	ONE	7
8	28.12.05	ONE	8
9	28.12.05	ONE	9
10	28.12.05	ONE	10
11	28.12.05	ONE	11
12	28.12.05	ONE	12
13	28.12.05	ONE	13
14	28.12.05	ONE	14
15	28.12.05	ONE	15
16	28.12.05	ONE	16
17	28.12.05	ONE	17
18	28.12.05	ONE	18
19	28.12.05	ONE	19
20	28.12.05	ONE	20
21	28.12.05	ONE	21
22	28.12.05	ONE	22
23	28.12.05	ONE	23
24	28.12.05	ONE	24
25	28.12.05	ONE	25
26	28.12.05	ONE	26
27	28.12.05	ONE	27
28	28.12.05	ONE	28
29	28.12.05	ONE	29
30	28.12.05	ONE	30

30kW
54Amp

Control cabinet

MCC unit M14200

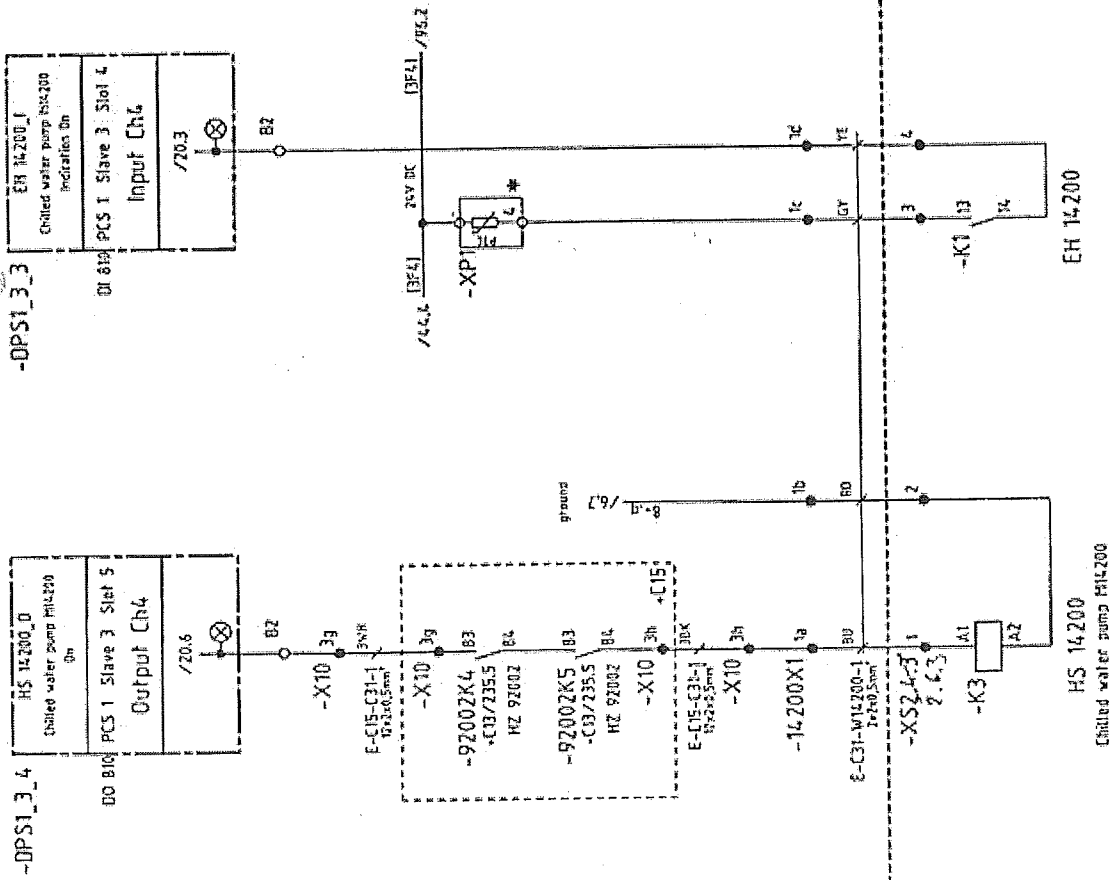

OK
26.3.06
11A

Date		11.03.2005	ASU Kosice		AIR LIQUIDE		Circuit diagram		K.70101		-C31		DATE		5h	
Made		Parametrisation					DC/AC									
Check							H/E 14200, P813									
Name							chill tower									
Signature							pump 2									
Date																
Signature																
Date																
Signature																

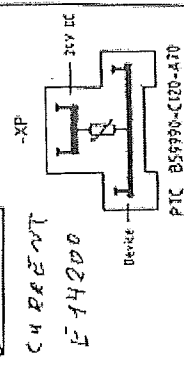

PIC B59990-C120-A70

1		2		3		4		5		6		7		8	
<div> <div> <div>400V AC : 3/PE</div> <div>50Hz : 50kA / 1sek.</div> </div> </div>															
<div> <div>8.8/L1</div> <div>8.8/L2</div> <div>8.8/L3</div> </div>															
<div> <div>8.5/LS1</div> <div>8.5/LS2</div> <div>8.5/NS1</div> <div>8.2/PE</div> </div>															
<div> <div>LS1/10.1</div> <div>LS2/10.1</div> <div>NS1/10.1</div> <div>PE/10.1</div> </div>															

Date		07.05.05		Act		LVMD		RREVA		AIR		Reserve		Zust.		Pa.		41		= LVMD	
Editor		Ottien		Ress		Kosice		Energiatechnik GmbH		Liquide				378 Pa.		+ Field					
Checked				System		LowVoltMainDistr		Created with EPLAN 5.50						Project-No.		1_169_05_20		Manufacturer-No.		3551/169-05	
Date		28.12.05		Name		BRE								Disk-No.				Ps.		9	
State		Rev03																Ps.		37 Pa.	

NOV 04 11:54 SCH 2: 100V 1 100V

Measurement
CURRENT

2. 10/11
7. 10/12
7. 10/13

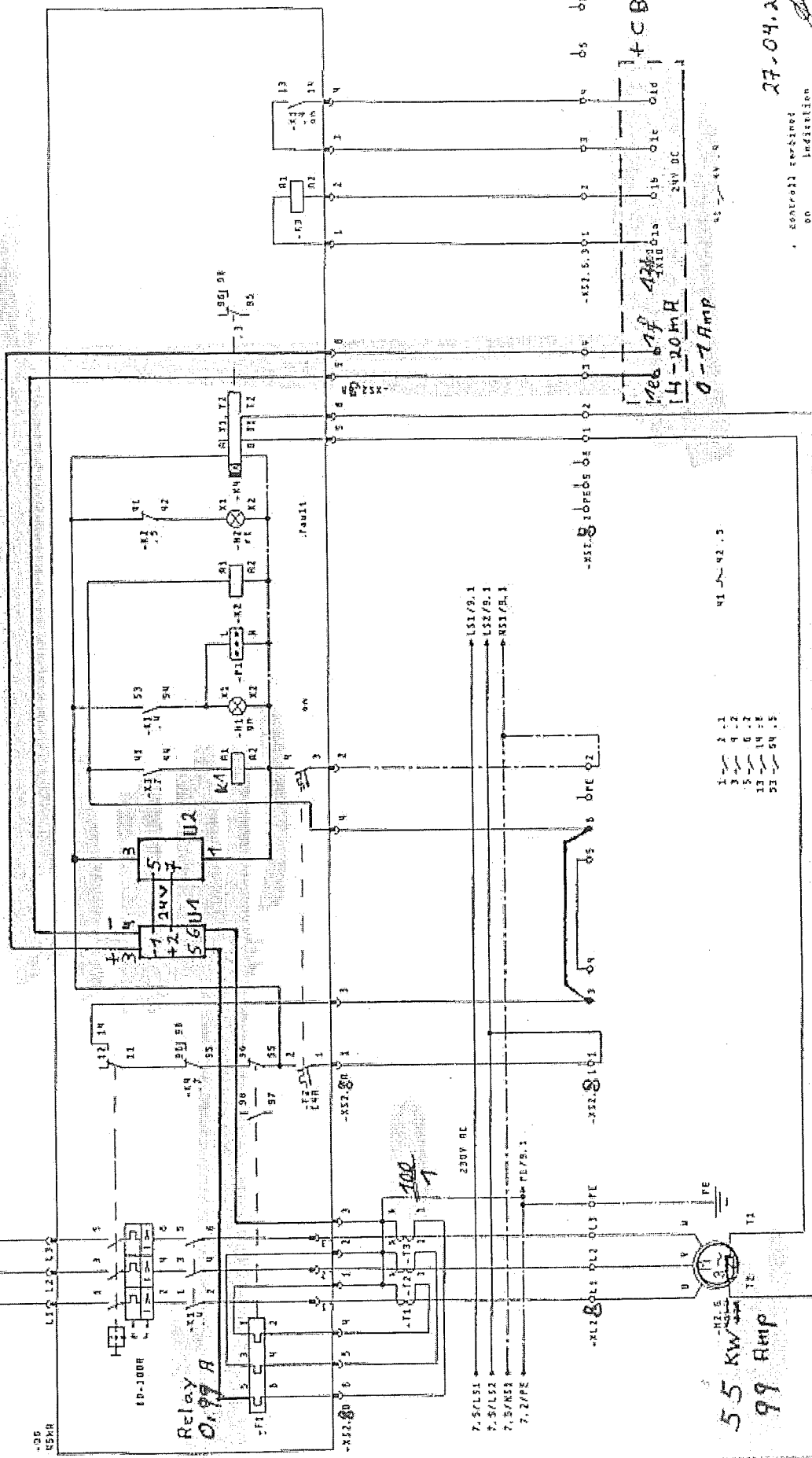

27-04-2006

Controlled revision
Indication

Rev	Date	By	Check	Drawn	Scale	Notes	Project	Sheet	Total
Rev03	28.12.05	SE	Rev02	Rev01	Rev00	Rev00	1.103.01.20	3551/103-05	37
Rev02	28.12.05	SE	Rev01	Rev00	Rev00	Rev00	1.103.01.20	3551/103-05	37
Rev01	28.12.05	SE	Rev00	Rev00	Rev00	Rev00	1.103.01.20	3551/103-05	37
Rev00	28.12.05	SE	Rev00	Rev00	Rev00	Rev00	1.103.01.20	3551/103-05	37

DC/AC
pump 1

HCC Unit
M3300

MTR
Liquide

ARECO
Energetische GmbH

Rev03
28.12.05

Rev02
28.12.05

Rev01
28.12.05

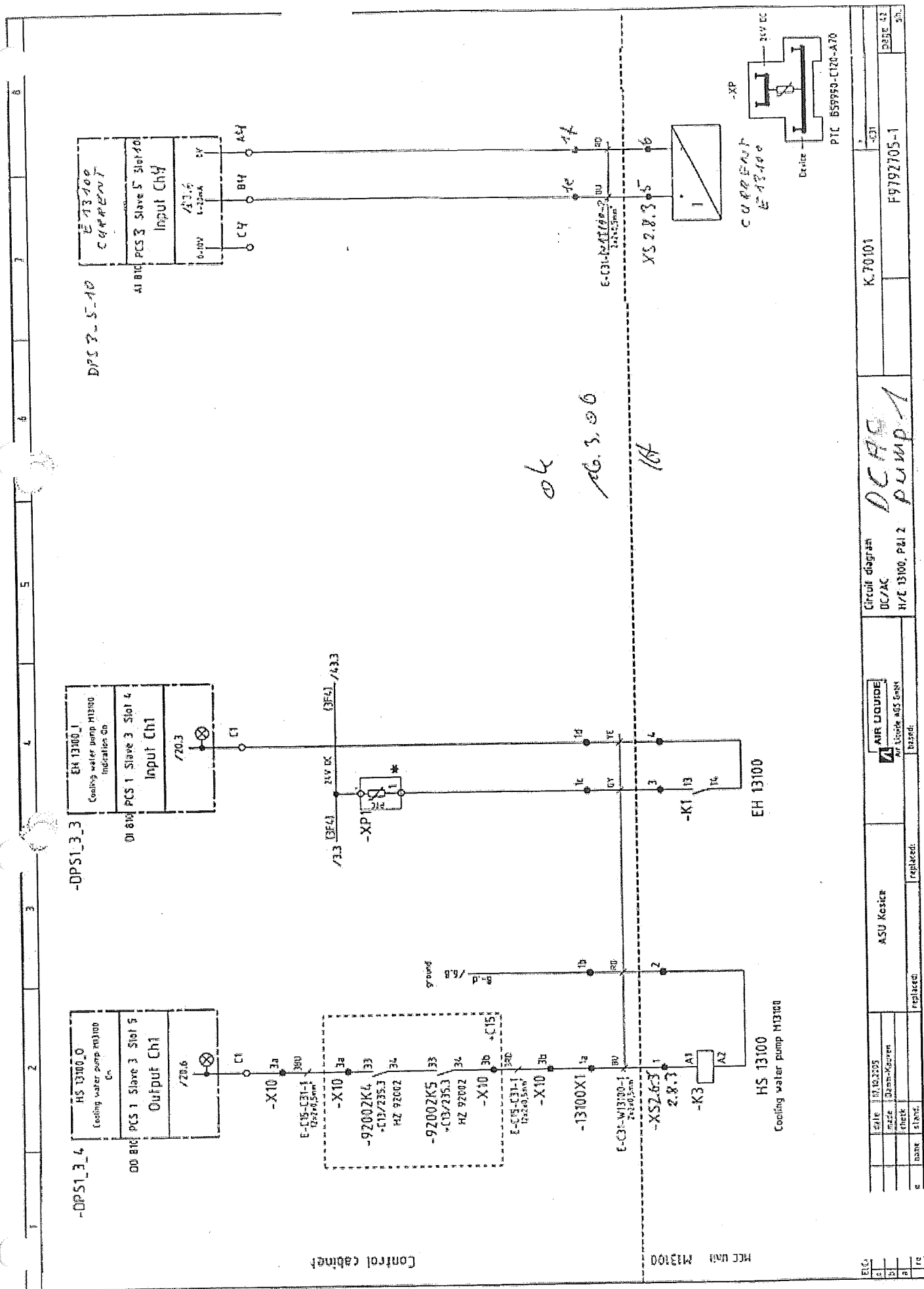

10	9	8	7	6	5	4	3	2	1
----	---	---	---	---	---	---	---	---	---

480V AC 3P/4E 50Hz : 50kV / 11kV

Measurement
Circuit

7.8/11
7.8/12
7.8/13
7.8/14
7.8/15
7.8/16
7.8/17
7.8/18
7.8/19
7.8/20
7.8/21
7.8/22
7.8/23
7.8/24
7.8/25
7.8/26
7.8/27
7.8/28
7.8/29
7.8/30
7.8/31
7.8/32
7.8/33
7.8/34
7.8/35
7.8/36
7.8/37
7.8/38
7.8/39
7.8/40
7.8/41
7.8/42
7.8/43
7.8/44
7.8/45
7.8/46
7.8/47
7.8/48
7.8/49
7.8/50
7.8/51
7.8/52
7.8/53
7.8/54
7.8/55
7.8/56
7.8/57
7.8/58
7.8/59
7.8/60
7.8/61
7.8/62
7.8/63
7.8/64
7.8/65
7.8/66
7.8/67
7.8/68
7.8/69
7.8/70
7.8/71
7.8/72
7.8/73
7.8/74
7.8/75
7.8/76
7.8/77
7.8/78
7.8/79
7.8/80
7.8/81
7.8/82
7.8/83
7.8/84
7.8/85
7.8/86
7.8/87
7.8/88
7.8/89
7.8/90
7.8/91
7.8/92
7.8/93
7.8/94
7.8/95
7.8/96
7.8/97
7.8/98
7.8/99
7.8/100

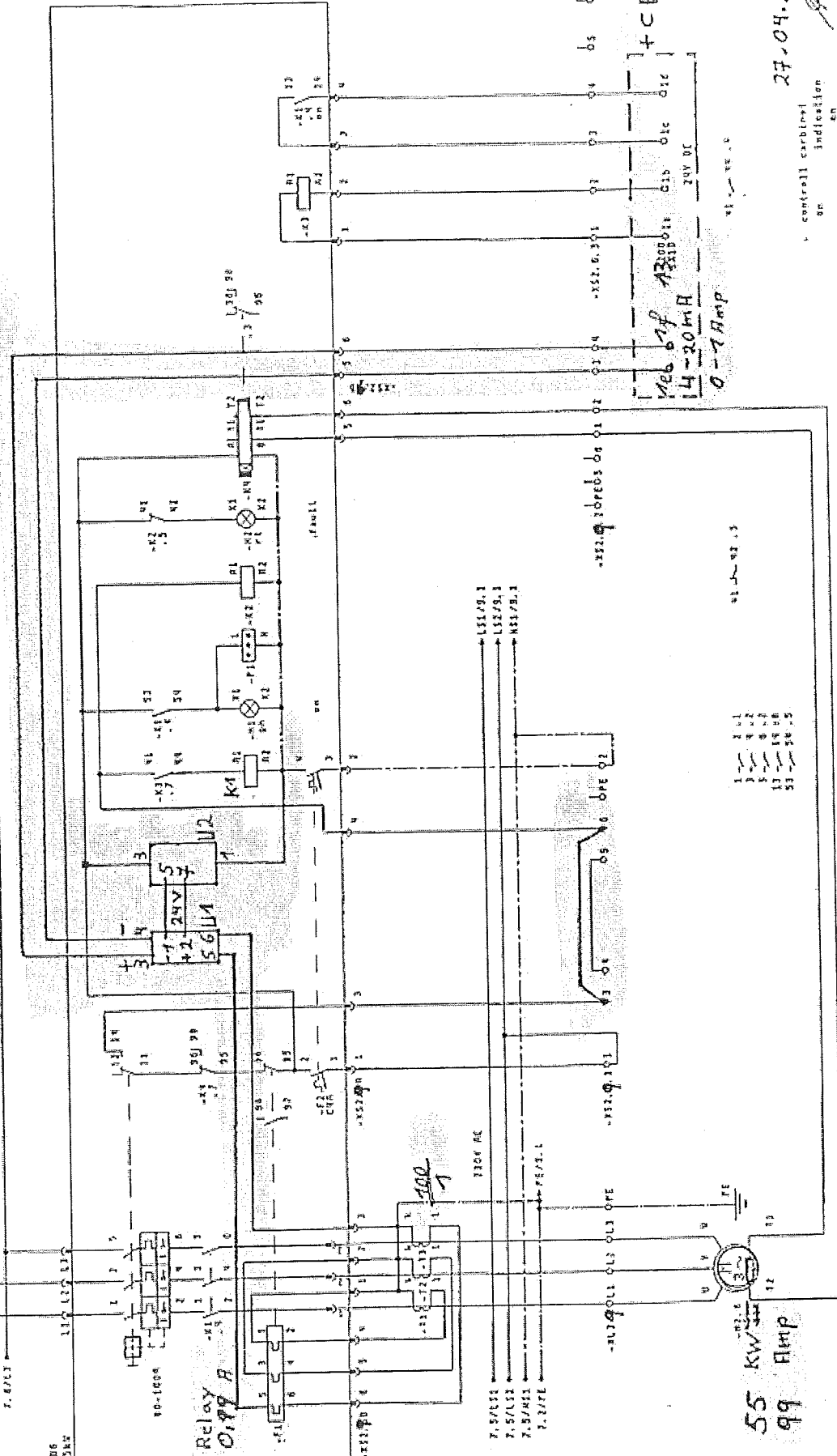

27.04.2006
control carburettor
on indication

DCAC pump 2

MCC Unit H3200

AIR Liquide

Emergency Stop

Control with remote line

Low Voltage Protection

Emergency Stop

Emergency Stop

Emergency Stop

Emergency Stop

Emergency Stop

Emergency Stop

Control cabinet

MCC Unit M13200

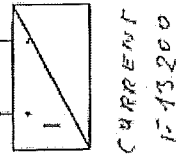
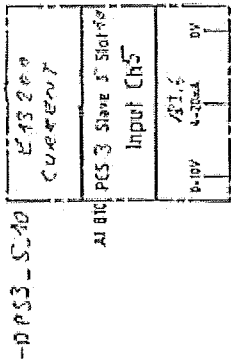
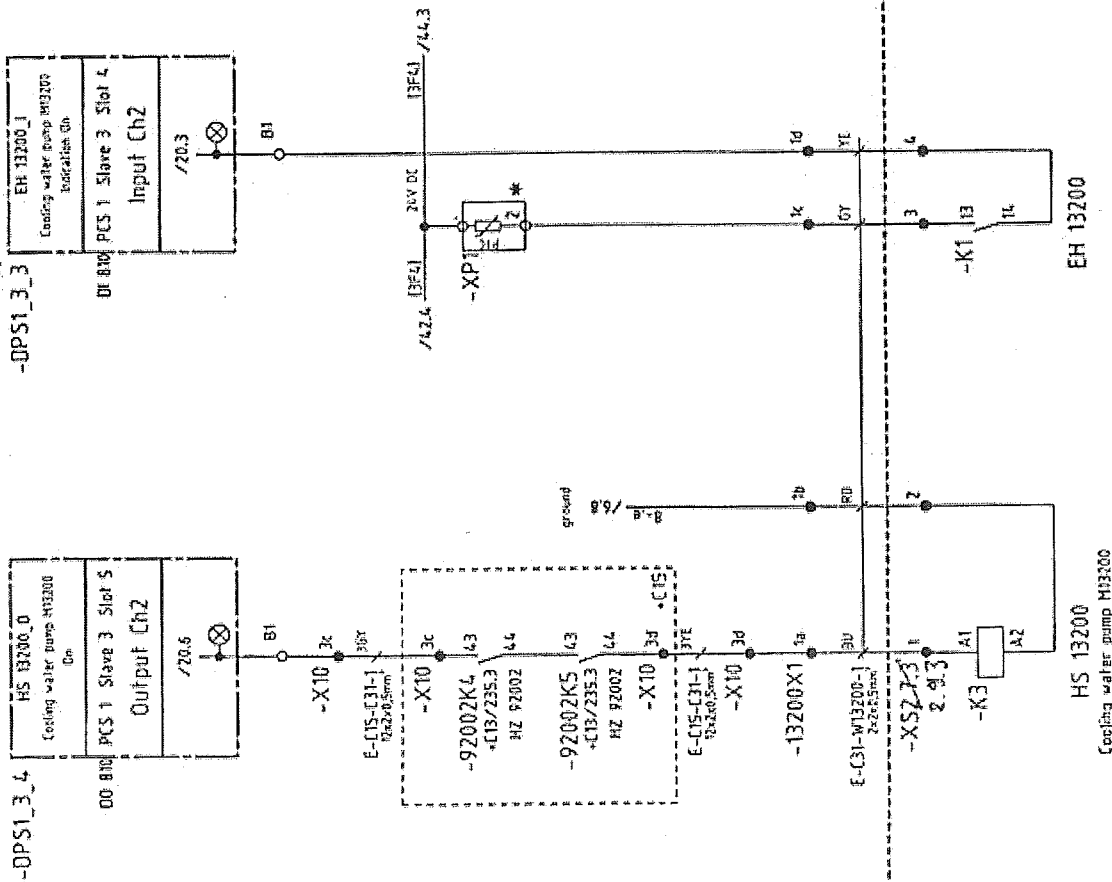

date	12.10.2005	ASU Koste	Circuit diagram	K.70101	DATE 43
made	Dr. K. Koste		DC/AC		50
check			H/E 13200, P&I 2	F9792705-1	
name					
status					
replaced					
based					

[illegible]

[illegible]

[illegible]

terminal block: +Field2-XS2.6.3

and

notes and
identification

LINE
CLASS NUMBER

and

notes and
identification

4CB-142001X10 C31-X1: 1a
4CB-142001X10 C31-X1: 1b
4CB-142001X10 C31-X1: 1c
4CB-142001X10 C31-X1: 1d

1 -XS2.6B
2 -XS2.6B
3 -XS2.6B
4 -XS2.6B

5

6

PE

4Field2-XS2.6.3

RIP
Liquide

BRERA
Energietechnik GmbH
Revised 10/10/2003

10/10/2003
Revised
10/10/2003

10/10/2003
Revised
10/10/2003

10/10/2003
Revised
10/10/2003

10/10/2003
Revised
10/10/2003

10/10/2003
Revised
10/10/2003

10/10/2003
Revised
10/10/2003

10/10/2003
Revised
10/10/2003

10/10/2003
Revised
10/10/2003

10/10/2003
Revised
10/10/2003

10/10/2003
Revised
10/10/2003

[illegible]

[illegible]

[illegible]

[illegible]

[illegible]

[illegible]

terminal block: +Field2-XS2.90

and
notes and
identification

blank

and
notes and
identification

1 -LYND-09-F1
2 -LYND-09-F1
3 -LYND-09-F1
4 -LYND-09-F1
5 -LYND-09-F1
6 -LYND-09-F1

+Field2-XS2.90

blank

and
notes and
identification

1 -LYND-09-F1
2 -LYND-09-F1
3 -LYND-09-F1
4 -LYND-09-F1
5 -LYND-09-F1
6 -LYND-09-F1

1 -LYND-09-F1
2 -LYND-09-F1
3 -LYND-09-F1
4 -LYND-09-F1
5 -LYND-09-F1
6 -LYND-09-F1

1 -LYND-09-F1
2 -LYND-09-F1
3 -LYND-09-F1
4 -LYND-09-F1
5 -LYND-09-F1
6 -LYND-09-F1

1 -LYND-09-F1
2 -LYND-09-F1
3 -LYND-09-F1
4 -LYND-09-F1
5 -LYND-09-F1
6 -LYND-09-F1

1 -LYND-09-F1
2 -LYND-09-F1
3 -LYND-09-F1
4 -LYND-09-F1
5 -LYND-09-F1
6 -LYND-09-F1

1 -LYND-09-F1
2 -LYND-09-F1
3 -LYND-09-F1
4 -LYND-09-F1
5 -LYND-09-F1
6 -LYND-09-F1

[illegible]

400V AC : 3/VE 50Hz : 500A / 120V

2.8/1.1
2.8/1.2
2.8/1.3
2.8/1.4
2.8/1.5
2.8/1.6
2.8/1.7
2.8/1.8
2.8/1.9
2.8/1.10
2.8/1.11
2.8/1.12
2.8/1.13
2.8/1.14
2.8/1.15
2.8/1.16
2.8/1.17
2.8/1.18
2.8/1.19
2.8/1.20
2.8/1.21
2.8/1.22
2.8/1.23
2.8/1.24
2.8/1.25
2.8/1.26
2.8/1.27
2.8/1.28
2.8/1.29
2.8/1.30
2.8/1.31
2.8/1.32
2.8/1.33
2.8/1.34
2.8/1.35
2.8/1.36
2.8/1.37
2.8/1.38
2.8/1.39
2.8/1.40
2.8/1.41
2.8/1.42
2.8/1.43
2.8/1.44
2.8/1.45
2.8/1.46
2.8/1.47
2.8/1.48
2.8/1.49
2.8/1.50
2.8/1.51
2.8/1.52
2.8/1.53
2.8/1.54
2.8/1.55
2.8/1.56
2.8/1.57
2.8/1.58
2.8/1.59
2.8/1.60
2.8/1.61
2.8/1.62
2.8/1.63
2.8/1.64
2.8/1.65
2.8/1.66
2.8/1.67
2.8/1.68
2.8/1.69
2.8/1.70
2.8/1.71
2.8/1.72
2.8/1.73
2.8/1.74
2.8/1.75
2.8/1.76
2.8/1.77
2.8/1.78
2.8/1.79
2.8/1.80
2.8/1.81
2.8/1.82
2.8/1.83
2.8/1.84
2.8/1.85
2.8/1.86
2.8/1.87
2.8/1.88
2.8/1.89
2.8/1.90
2.8/1.91
2.8/1.92
2.8/1.93
2.8/1.94
2.8/1.95
2.8/1.96
2.8/1.97
2.8/1.98
2.8/1.99
2.8/1.100

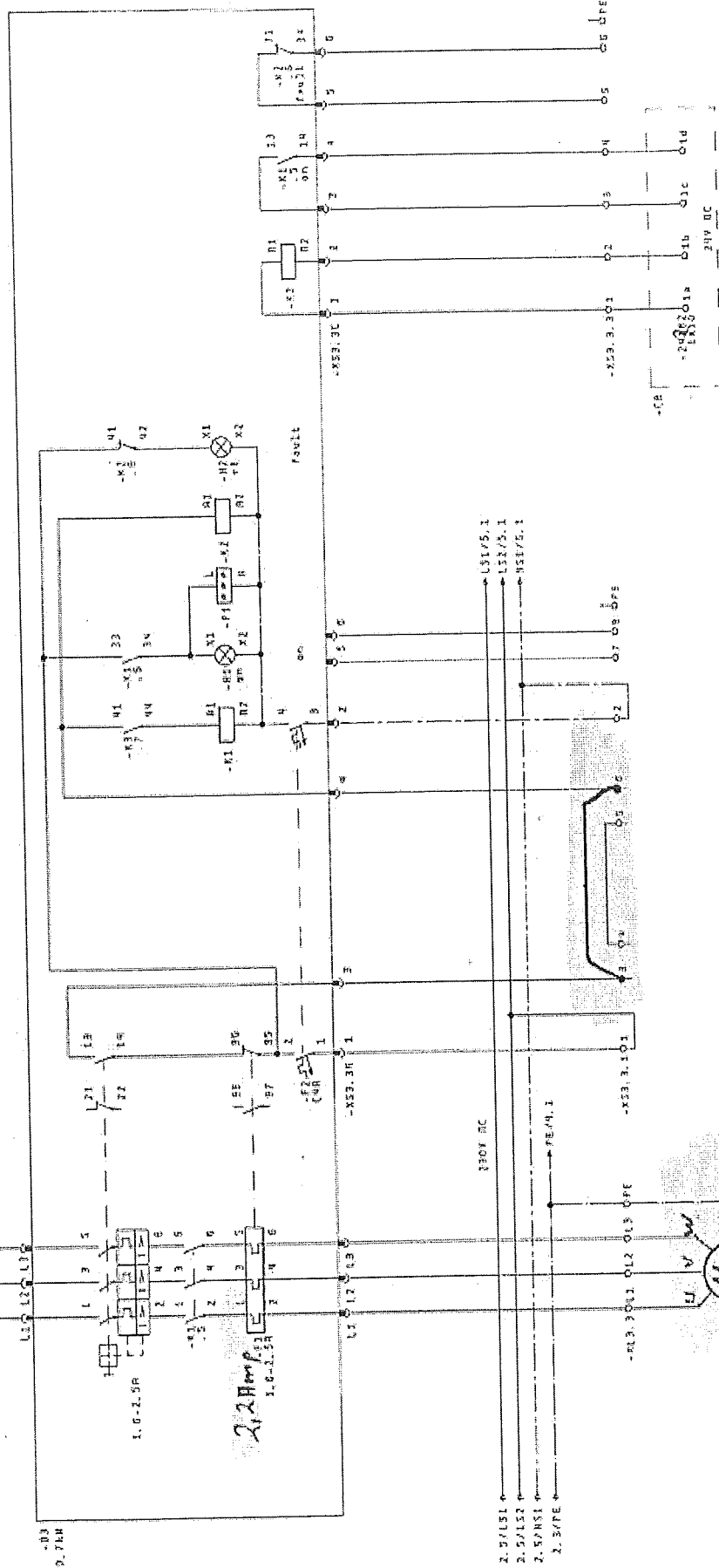

0.7 kW
2.2 Amp

control) carbinal
on indication

Oil demister
HCC Unit
Turbine 2

oil
liquide

Electrotechnique G&M

Electrotechnique G&M

Electrotechnique G&M

Electrotechnique G&M

Electrotechnique G&M

Electrotechnique G&M

discon. KH/A

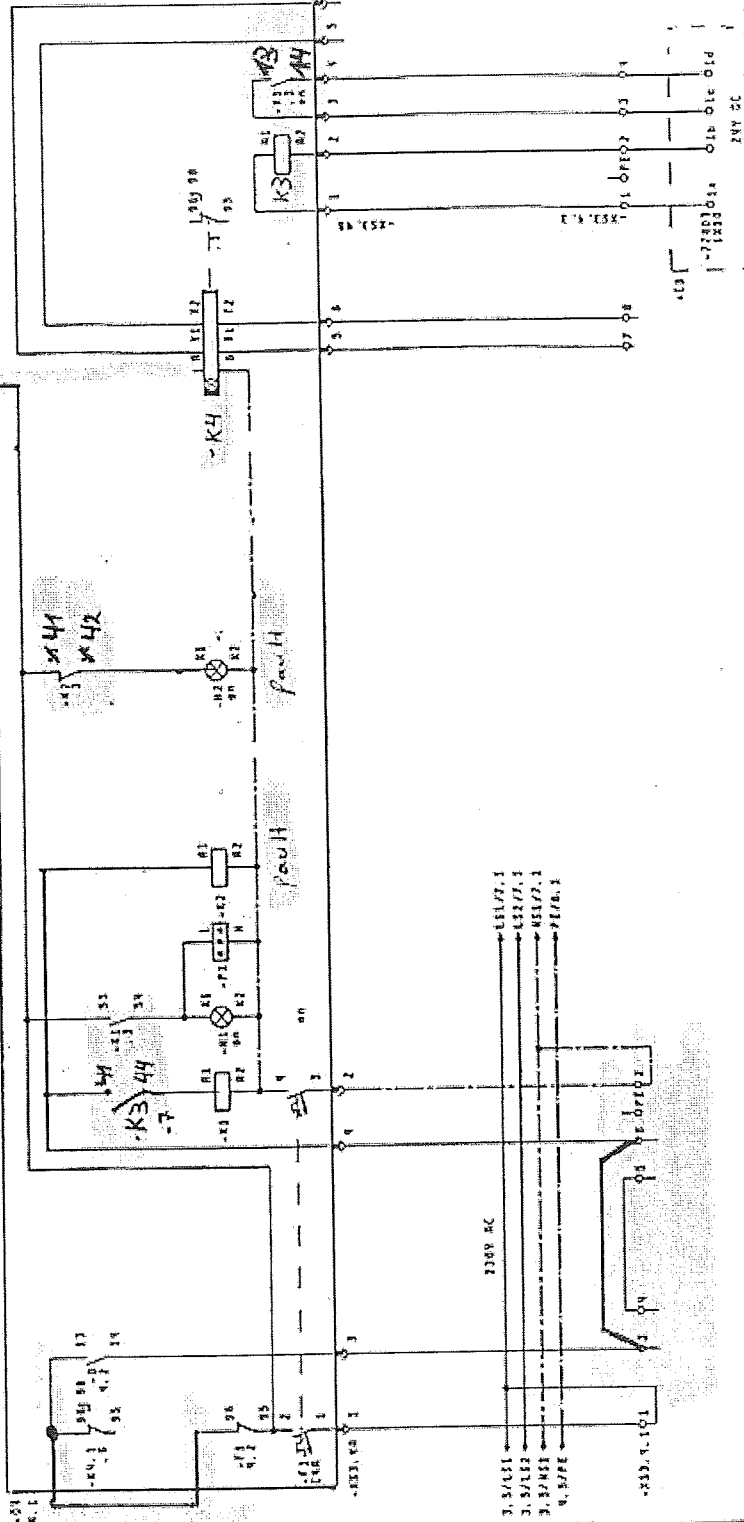

28.04.2006

Control terminal
on indication

1-2 4.1
3-4 4.2
5-6 4.3
7-8 4.4
9-10 4.5
11-12 4.6
13-14 4.7

Emergency stop

HCC Unit GAN 2
N77803

RIN
Liquide

ENERGIE
Energie-Technik GmbH
Energie-Technik GmbH

Low Voltage
Low Voltage

DATE 07.05.03
BY 01.05.03
REV 01.05.03

DATE 19.12.05
BY 19.12.05
REV 19.12.05

DATE 18.12.05-12.06.06
BY 18.12.05-12.06.06
REV 18.12.05-12.06.06

107

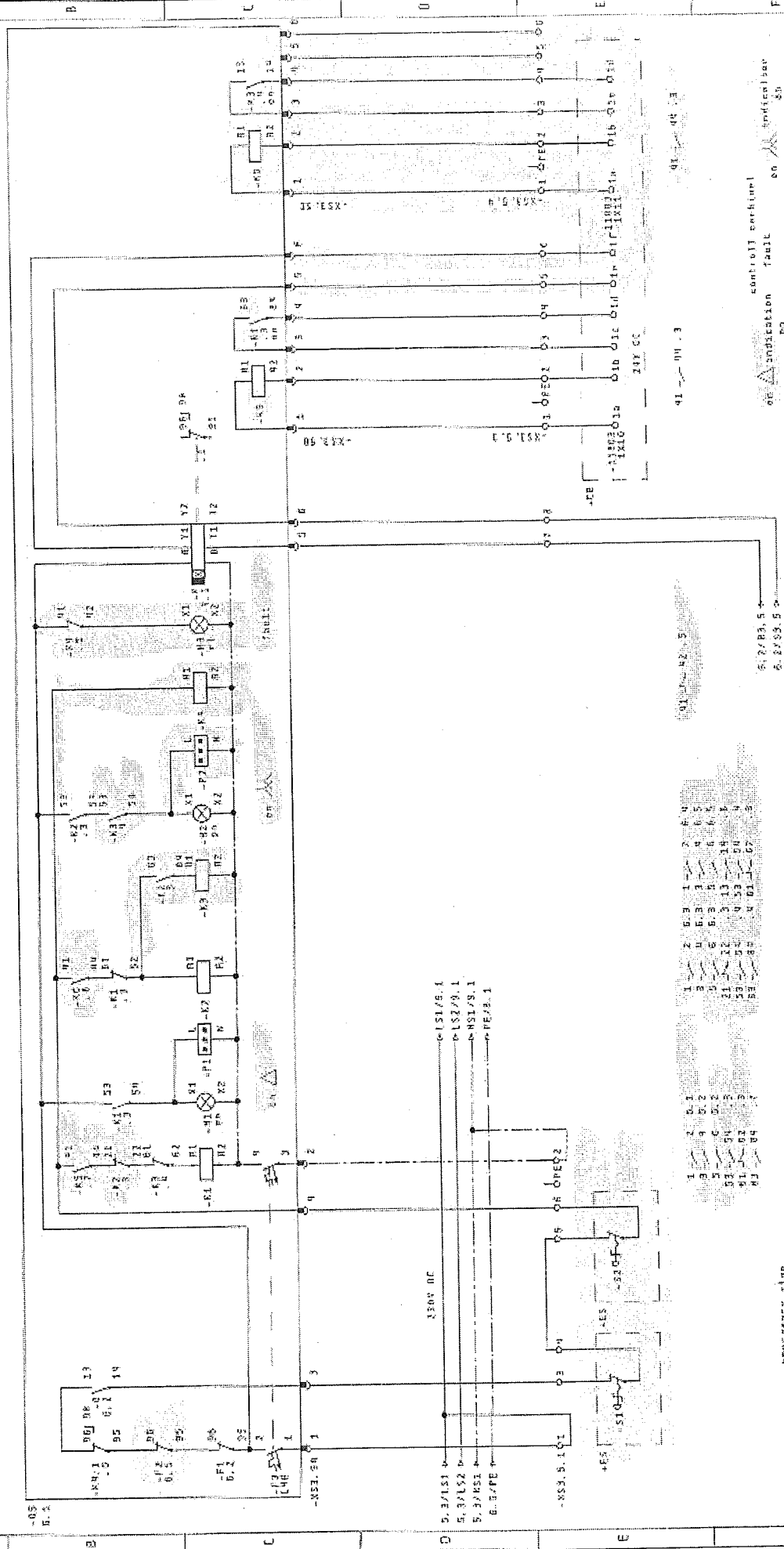
[illegible]

all out

[illegible]

[illegible]

Attention. The change over switch on the Broken must be in automatic position for operating remote.

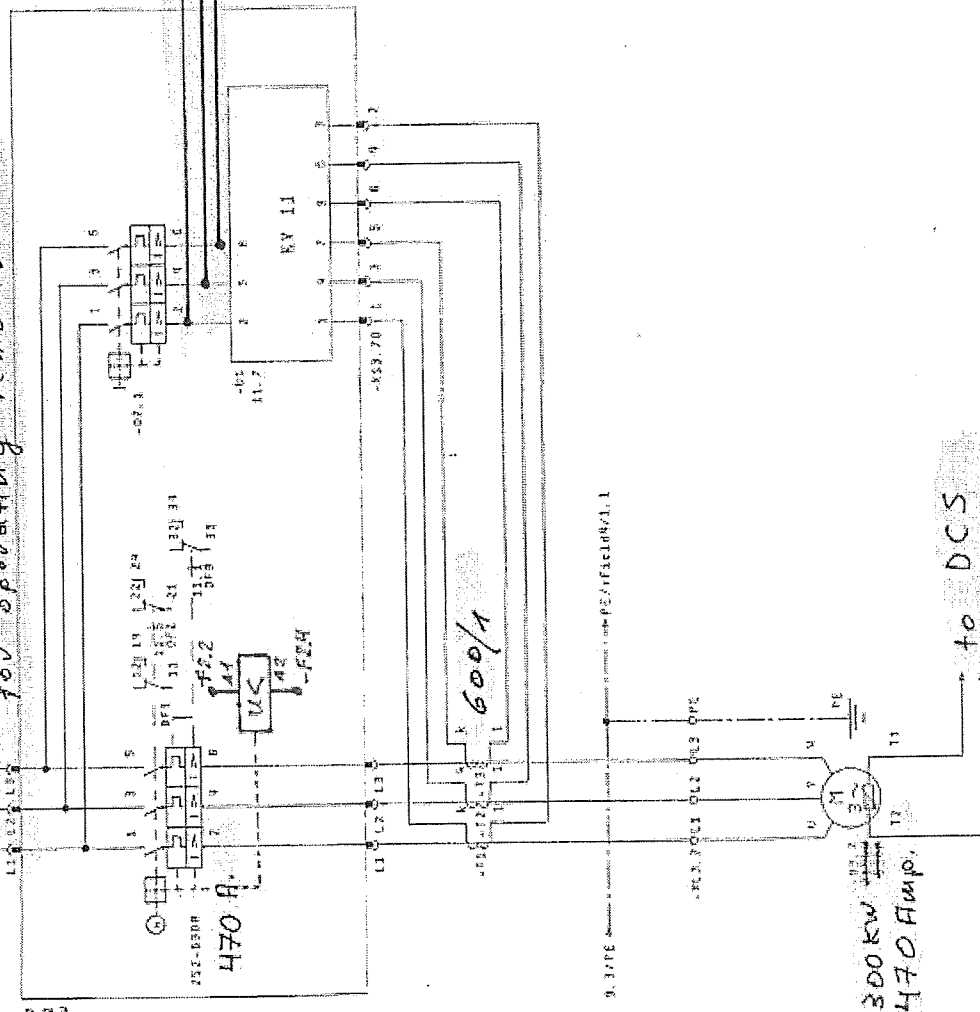

EH44
F500-2
voltage relay
412

Bob + Jan

27.04.2006

[illegible]

1		2		3		4		5		6		7		8		9		10		11		12	
terminal block: 4Field3-XS3.20																							
notes and identification												notes and identification											
end												end											
class number												class number											
1												1											
2												2											
3												3											
4												4											
5												5											
6												6											
7												7											
8												8											
9												9											
10												10											
11												11											
12												12											
13												13											
14												14											
15												15											
16												16											
17												17											
18												18											
19												19											
20												20											
21												21											
22												22											
23												23											
24												24											
25												25											
26												26											
27												27											
28												28											
29												29											
30												30											
31												31											
32												32											
33												33											
34												34											
35												35											
36												36											
37												37											
38												38											
39												39											
40												40											
41												41											
42												42											
43												43											
44												44											
45												45											
46												46											
47												47											
48												48											
49												49											
50												50											
51												51											
52												52											
53												53											
54												54											
55												55											
56												56											
57												57											
58												58											
59												59											
60												60											
61												61											
62												62											
63												63											
64												64											
65												65											
66												66											
67												67											
68												68											
69												69											
70												70											
71												71											
72												72											
73												73											
74												74											
75												75											
76												76											
77												77											
78												78											
79												79											
80												80											
81												81											
82												82											
83												83											
84												84											
85												85											
86												86											
87												87											
88												88											
89												89											
90												90											
91												91											
92												92											
93												93											
94												94											
95												95											
96												96											
97												97											
98												98											
99												99											
100												100											

terminal block: 4Field3-XS3.20

notes and identification

end

class number

1

2

3

4

5

6

7

8

9

10

11

12

13

14

15

16

17

18

19

20

21

22

23

24

25

26

27

28

29

30

31

32

33

34

35

36

37

38

39

40

41

42

43

44

45

46

47

48

49

50

51

52

53

54

55

56

57

58

59

60

61

62

63

64

65

66

67

68

69

70

71

72

73

74

75

76

77

78

79

80

81

82

83

84

85

86

87

88

89

90

91

92

93

94

95

96

97

98

99

100

[illegible]

	1	2	3	4	5	6	7	8	9	10	11	12	13	14	15	16	17	18	19	20	21	22	23	24	25	26	27	28	29	30	31	32	33	34	35	36	37	38	39	40	41	42	43	44	45	46	47	48	49	50	51	52	53	54	55	56	57	58	59	60	61	62	63	64	65	66	67	68	69	70	71	72	73	74	75	76	77	78	79	80	81	82	83	84	85	86	87	88	89	90	91	92	93	94	95	96	97	98	99	100	101	102	103	104	105	106	107	108	109	110	111	112	113	114	115	116	117	118	119	120	121	122	123	124	125	126	127	128	129	130	131	132	133	134	135	136	137	138	139	140	141	142	143	144	145	146	147	148	149	150	151	152	153	154	155	156	157	158	159	160	161	162	163	164	165	166	167	168	169	170	171	172	173	174	175	176	177	178	179	180	181	182	183	184	185	186	187	188	189	190	191	192	193	194	195	196	197	198	199	200	201	202	203	204	205	206	207	208	209	210	211	212	213	214	215	216	217	218	219	220	221	222	223	224	225	226	227	228	229	230	231	232	233	234	235	236	237	238	239	240	241	242	243	244	245	246	247	248	249	250	251	252	253	254	255	256	257	258	259	260	261	262	263	264	265	266	267	268	269	270	271	272	273	274	275	276	277	278	279	280	281	282	283	284	285	286	287	288	289	290	291	292	293	294	295	296	297	298	299	300	301	302	303	304	305	306	307	308	309	310	311	312	313	314	315	316	317	318	319	320	321	322	323	324	325	326	327	328	329	330	331	332	333	334	335	336	337	338	339	340	341	342	343	344	345	346	347	348	349	350	351	352	353	354	355	356	357	358	359	360	361	362	363	364	365	366	367	368	369	370	371	372	373	374	375	376	377	378	379	380	381	382	383	384	385	386	387	388	389	390	391	392	393	394	395	396	397	398	399	400	401	402	403	404	405	406	407	408	409	410	411	412	413	414	415	416	417	418	419	420	421	422	423	424	425	426	427	428	429	430	431	432	433	434	435	436	437	438	439	440	441	442	443	444	445	446	447	448	449	450	451	452	453	454	455	456	457	458	459	460	461	462	463	464	465	466	467	468	469	470	471	472	473	474	475	476	477	478	479	480	481	482	483	484	485	486	487	488	489	490	491	492	493	494	495	496	497	498	499	500	501	502	503	504	505	506	507	508	509	510	511	512	513	514	515	516	517	518	519	520	521	522	523	52
--	---	---	---	---	---	---	---	---	---	----	----	----	----	----	----	----	----	----	----	----	----	----	----	----	----	----	----	----	----	----	----	----	----	----	----	----	----	----	----	----	----	----	----	----	----	----	----	----	----	----	----	----	----	----	----	----	----	----	----	----	----	----	----	----	----	----	----	----	----	----	----	----	----	----	----	----	----	----	----	----	----	----	----	----	----	----	----	----	----	----	----	----	----	----	----	----	----	----	----	-----	-----	-----	-----	-----	-----	-----	-----	-----	-----	-----	-----	-----	-----	-----	-----	-----	-----	-----	-----	-----	-----	-----	-----	-----	-----	-----	-----	-----	-----	-----	-----	-----	-----	-----	-----	-----	-----	-----	-----	-----	-----	-----	-----	-----	-----	-----	-----	-----	-----	-----	-----	-----	-----	-----	-----	-----	-----	-----	-----	-----	-----	-----	-----	-----	-----	-----	-----	-----	-----	-----	-----	-----	-----	-----	-----	-----	-----	-----	-----	-----	-----	-----	-----	-----	-----	-----	-----	-----	-----	-----	-----	-----	-----	-----	-----	-----	-----	-----	-----	-----	-----	-----	-----	-----	-----	-----	-----	-----	-----	-----	-----	-----	-----	-----	-----	-----	-----	-----	-----	-----	-----	-----	-----	-----	-----	-----	-----	-----	-----	-----	-----	-----	-----	-----	-----	-----	-----	-----	-----	-----	-----	-----	-----	-----	-----	-----	-----	-----	-----	-----	-----	-----	-----	-----	-----	-----	-----	-----	-----	-----	-----	-----	-----	-----	-----	-----	-----	-----	-----	-----	-----	-----	-----	-----	-----	-----	-----	-----	-----	-----	-----	-----	-----	-----	-----	-----	-----	-----	-----	-----	-----	-----	-----	-----	-----	-----	-----	-----	-----	-----	-----	-----	-----	-----	-----	-----	-----	-----	-----	-----	-----	-----	-----	-----	-----	-----	-----	-----	-----	-----	-----	-----	-----	-----	-----	-----	-----	-----	-----	-----	-----	-----	-----	-----	-----	-----	-----	-----	-----	-----	-----	-----	-----	-----	-----	-----	-----	-----	-----	-----	-----	-----	-----	-----	-----	-----	-----	-----	-----	-----	-----	-----	-----	-----	-----	-----	-----	-----	-----	-----	-----	-----	-----	-----	-----	-----	-----	-----	-----	-----	-----	-----	-----	-----	-----	-----	-----	-----	-----	-----	-----	-----	-----	-----	-----	-----	-----	-----	-----	-----	-----	-----	-----	-----	-----	-----	-----	-----	-----	-----	-----	-----	-----	-----	-----	-----	-----	-----	-----	-----	-----	-----	-----	-----	-----	-----	-----	-----	-----	-----	-----	-----	-----	-----	-----	-----	-----	-----	-----	-----	-----	-----	-----	-----	-----	-----	-----	-----	-----	-----	-----	-----	-----	-----	-----	-----	-----	-----	-----	-----	-----	-----	-----	-----	-----	-----	-----	-----	-----	-----	-----	-----	-----	-----	-----	-----	-----	-----	-----	-----	-----	-----	-----	-----	-----	-----	-----	-----	-----	-----	-----	-----	-----	-----	-----	-----	-----	-----	-----	-----	-----	-----	-----	-----	-----	-----	-----	-----	-----	-----	-----	-----	-----	-----	-----	-----	-----	-----	-----	-----	-----	-----	-----	----

[illegible]

[illegible]